

Stage 3 Parking Schedule	
Level	Count
LEVEL B1	53
LEVEL B2	64
LEVEL B3	49
Grand total:	166

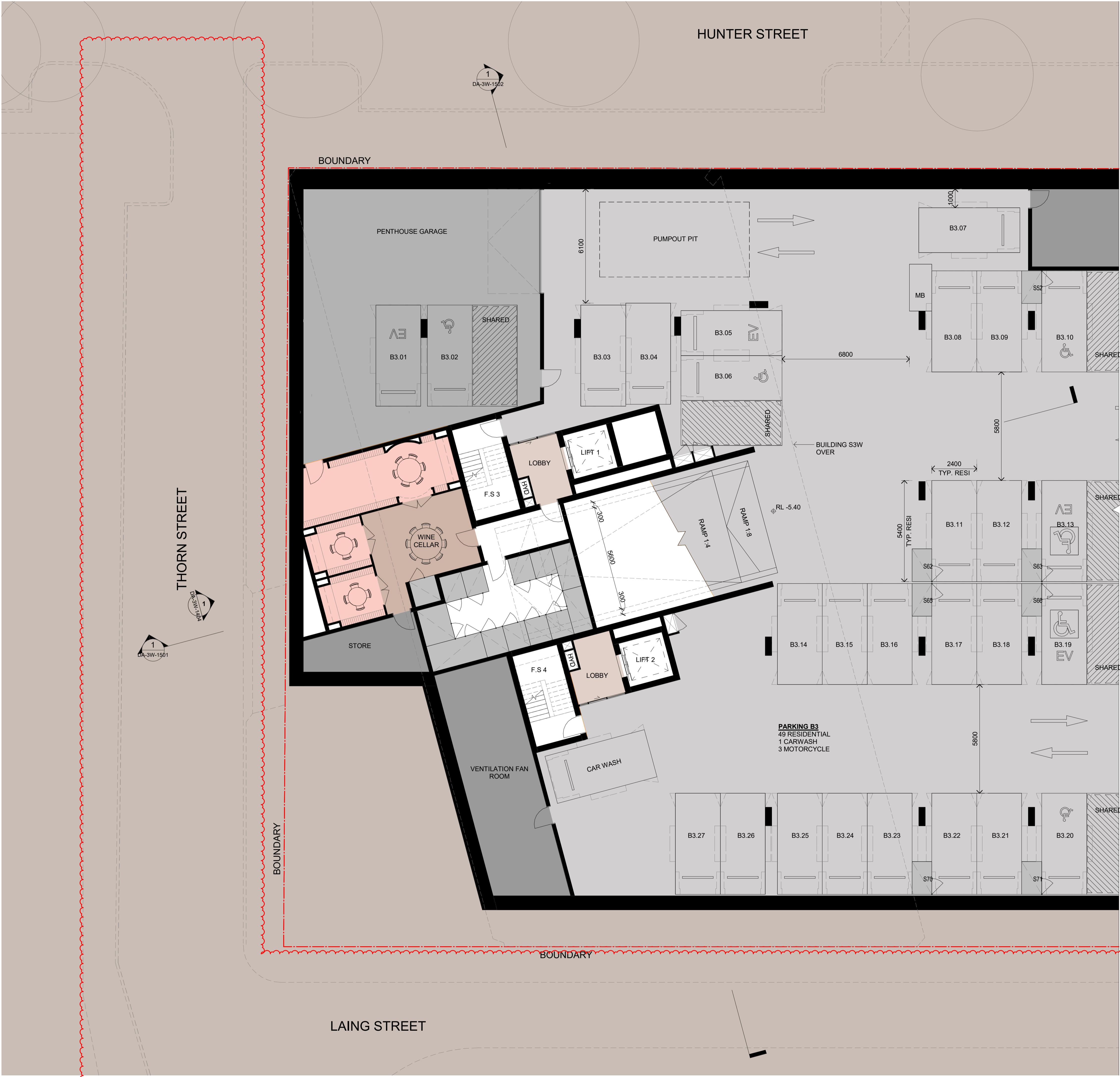

In accepting and utilising this document the recipient agrees that SJB Architecture (NSW) Pty. Ltd. ACN 081 094 724 T/A SJB Architects, retain all common law, statutory law and other rights including copyright and intellectual property rights. The recipient agrees not to use this document for any purpose other than its intended use; to waive all claims against SJB Architects resulting from unauthorised changes; or to reuse the document on other projects without prior written consent from SJB Architects. Under no circumstances shall transfer of this document be deemed a sale. SJB Architects makes no warranties of fitness for any purpose. The Builder/Contractor shall verify job dimensions prior to any work commencing. Use figured dimensions only. Do not scale drawings.

FOR APPROVAL

Rev	Date	Revision	By	Chk.
1	28.02.2023	FOR INFORMATION	JG	RY
2	08.03.2023	FOR INFORMATION	JG	RY
3	31.03.2023	ISSUE FOR DA	JG	RY
4	20.12.2023	ISSUE FOR COUNCIL	GS	RY
5	15.03.2024	COUNCIL RFI	SG	RY
6	15.10.2024	COUNCIL RFI	JG	WG

Precinct + Building 3W + 4S

SJB Architects
Level 2, 490 Crown St
Surry Hills NSW
2010 Australia
T 61 2 9380 9911
sjb.com.au



Building 3N & 3S

Durbach Block Jaggers
Level 2, 9 Roslyn St
Potts Point NSW
2011 Australia
T 61 2 8297 3500
durbachblockjaggers.com

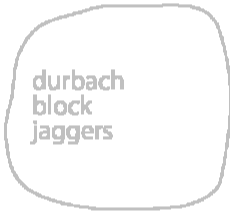

Building 4N

Curious Practice
24/526 Hunter Street,
Newcastle NSW
2300 Australia
T 61 4 1182 4600
curiouspractice.com

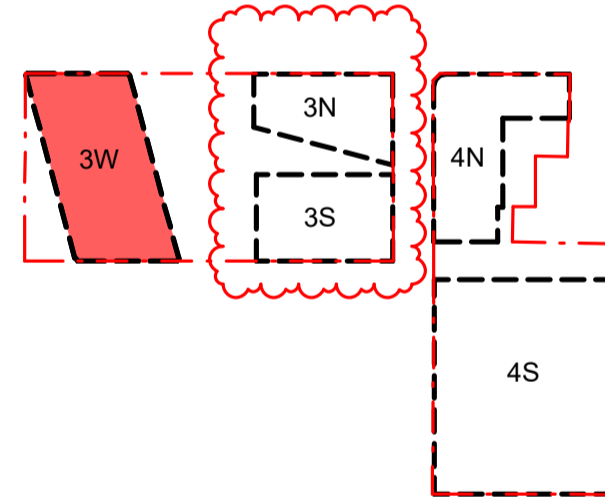

Client



Project

EAST END STAGE 3&4

Hunter, Morgan, Newcomen, King
Streets NEWCASTLE NSW 2300

Country: AWABAKAL

Drawing Name

**FLOOR PLAN - 3W -
BASEMENT 03**

Drawn

0 1 2 5m
1:100 @A1

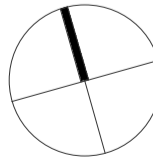

Date Scale Sheet Size

15.10.2024 As indicated @ A1

Drawn Chk. Revision

JG RY 6

Job No. Drawing No.

6668 DA-3W-1001

REFER TO DRAWING DA-3E-1001

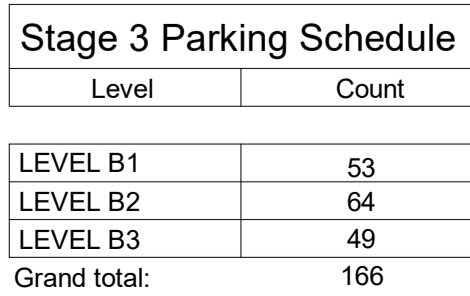

6668 DA-3W-1002

~~REFER TO DRAWING-DA-3F-1002~~

Stage 3 Parking Schedule	
Level	Count
LEVEL B1	53
LEVEL B2	64
LEVEL B3	49
Grand total:	166

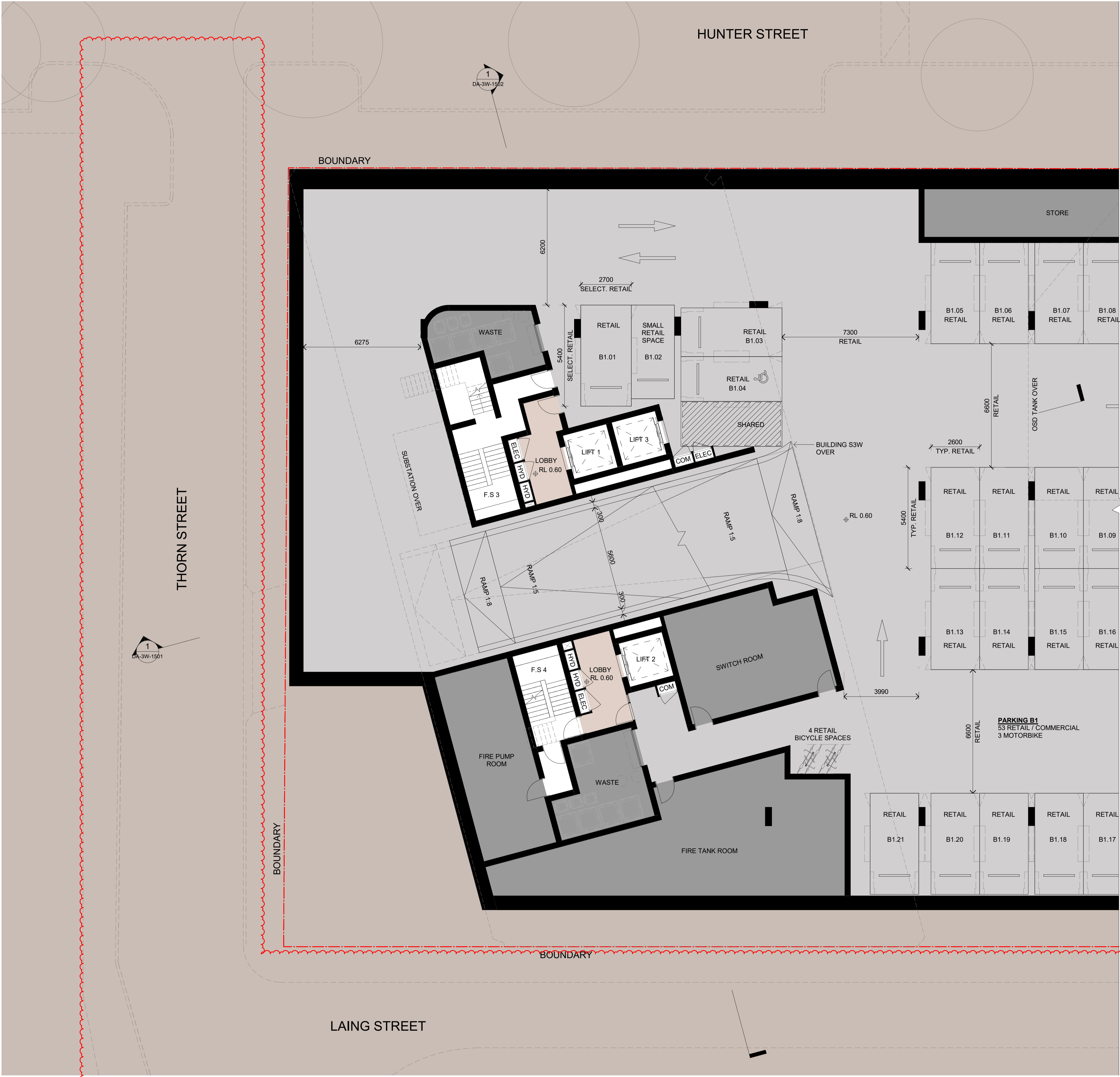

In accepting and utilising this document the recipient agrees that SJB Architecture (NSW) Pty. Ltd. ACN 081 094 724 T/A SJB Architects, retain all common law, statutory law and other rights including copyright and intellectual property rights. The recipient agrees not to use this document for any purpose other than its intended use; to waive all claims against SJB Architects resulting from unauthorised changes; or to reuse the document on other projects without prior written consent from SJB Architects. Under no circumstances shall transfer of this document be deemed a sale. SJB Architects makes no warranties of fitness for any purpose. The Builder/Contractor shall verify job dimensions prior to any work commencing. Use figured dimensions only. Do not scale drawings.

FOR APPROVAL

Rev	Date	Revision	By	Chk.
1	28.02.2023	FOR INFORMATION	JG	RY
2	08.03.2023	FOR INFORMATION	JG	RY
3	31.03.2023	ISSUE FOR DA	JG	RY
4	20.12.2023	ISSUE FOR COUNCIL	GS	RY
5	15.03.2024	COUNCIL RFI	SG	RY
6	15.10.2024	COUNCIL RFI	JG	WG

Precinct + Building 3W + 4S

SJB Architects
Level 2, 490 Crown St
Surry Hills NSW
2010 Australia
T 61 2 9380 9911
sjb.com.au



Building 3N & 3S

Durbach Block Jaggers
Level 2, 9 Roslyn St
Potts Point NSW
2011 Australia
T 61 2 8297 3500
durbachblockjaggers.com

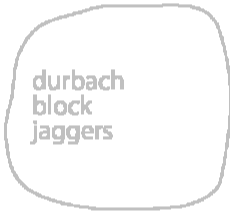

Building 4N

Curious Practice
24/526 Hunter Street,
Newcastle NSW
2300 Australia
T 61 4 1182 4600
curiouspractice.com

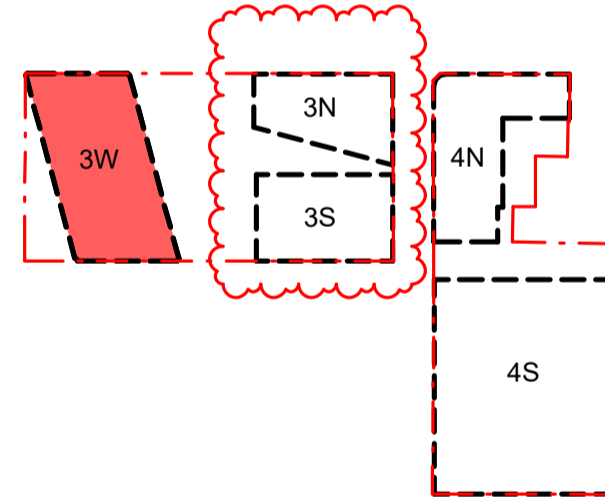

Client



Project

EAST END STAGE 3&4

Hunter, Morgan, Newcomen, King
Streets NEWCASTLE NSW 2300

Country: AWABAKAL

Drawing Name

**FLOOR PLAN - 3W -
BASEMENT 01**

Drawn

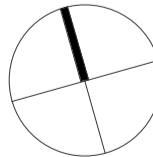
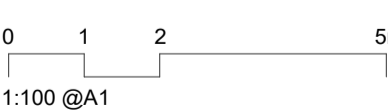

Date	Scale	Sheet Size
------	-------	------------

15.10.2024	As indicated	@ A1
------------	--------------	------

Drawn	Chk.	Revision
-------	------	----------

JG	RY	6
----	----	---

Job No.	Drawing No.
---------	-------------

6668	DA-3W-1003
------	------------



In accepting and utilising this document the recipient agrees that SJB Architecture (NSW) Pty. Ltd. ACN 081 094 724 T/A SJB Architects, retain all common law, statutory law and other rights including copyright and intellectual property rights. The recipient agrees not to use this document for any purpose other than its intended use; to waive all claims against SJB Architects resulting from unauthorised changes; or to reuse the document on other projects without prior written consent from SJB Architects. Under no circumstances shall transfer of this document be deemed a sale. SJB Architects makes no warranties of fitness for any purpose. The Builder/Contractor shall verify job dimensions prior to any work commencing. Use figured dimensions only. Do not scale drawings.

FOR APPROVAL

Rev	Date	Revision	By	Chk.
1	28.02.2023	FOR INFORMATION	JG	RY
2	08.03.2023	FOR INFORMATION	JG	RY
3	31.03.2023	ISSUE FOR DA	JG	RY
4	23.10.2023	FOR INFORMATION	JG	RY
5	12.02.2024	COUNCIL RFI	GS	RY
6	15.10.2024	COUNCIL RFI	JG	WG

Precinct + Building 3W + 4S
SJB Architects
Level 2, 490 Crown St
Surry Hills NSW
2010 Australia
T 61 2 9380 9911
sjb.com.au



Building 3N & 3S
Durbach Block Jaggers
Level 2, 9 Roslyn St
Potts Point NSW
2011 Australia
T 61 2 8297 3500
durbachblockjaggers.com

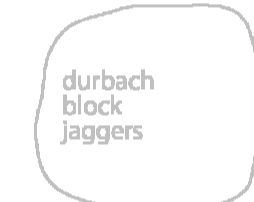

Building 4N
Curious Practice
24/526 Hunter Street,
Newcastle NSW
2300 Australia
T 61 4 1182 4600
curiouspractice.com

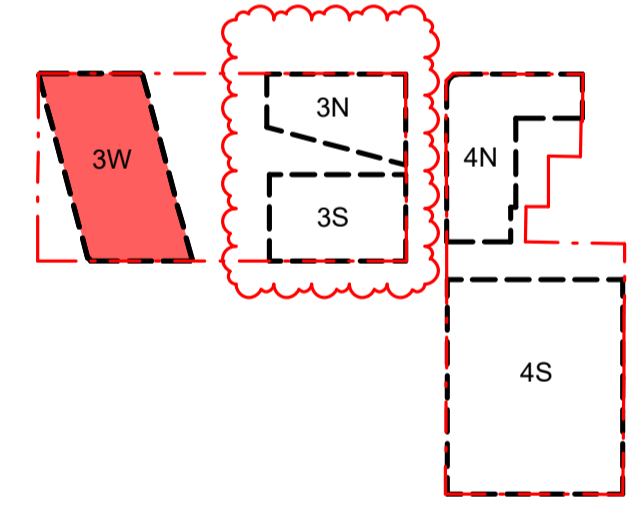

Client
iris

Project
EAST END STAGE 3&4
Hunter, Morgan, Newcomen, King
Streets NEWCASTLE NSW 2300
Country: AWABAKAL

Drawing Name
FLOOR PLAN - 3W - GROUND

Drawn
0 1 2 5m
1:100 @A1

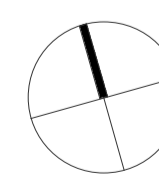

Date	Scale	Sheet Size
15.10.2024	1 : 100	@ A1
Drawn	Chk.	Revision
JG	RY	6
Job No.	Drawing No.	

6668 DA-3W-1004

REFER TO DRAWING DA-3E-1003

In accepting and utilising this document the recipient agrees that SJB Architecture (NSW) Pty. Ltd. ACN 081 094 724 T/A SJB Architects, retain all common law, statutory law and other rights including copyright and intellectual property rights. The recipient agrees not to use this document for any purpose other than its intended use, to waive all claims against SJB Architects resulting from unauthorised changes, or to reuse the document on other projects without prior written consent from SJB Architects. Under no circumstances shall transfer of this document be deemed a sale. SJB Architects makes no warranties of fitness for any purpose. The Builder/Contractor shall verify job dimensions prior to any work commencing. Use figured dimensions only. Do not scale drawings.

FOR APPROVAL

Rev	Date	Revision	By	Chk.
1	28.02.2023	FOR INFORMATION	JG	RY
2	08.03.2023	FOR INFORMATION	JG	RY
3	31.03.2023	ISSUE FOR DA	JG	RY
4	20.12.2023	ISSUE FOR COUNCIL	GS	RY
5	15.03.2024	COUNCIL RFI	SG	RY
6	15.10.2024	COUNCIL RFI	JG	WG

Precinct + Building 3W + 4S

SJB Architects
Level 2, 490 Crown St
Surry Hills NSW
2010 Australia
T 61 2 9380 9911
sjb.com.au



Building 3N & 3S

Durbach Block Jaggers
Level 2, 9 Roslyn St
Potts Point NSW
2011 Australia
T 61 2 8297 3500
durbachblockjaggers.com

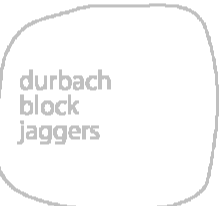

Building 4N

Curious Practice
24/526 Hunter Street,
Newcastle NSW
2300 Australia
T 61 4 1182 4600
curiouspractice.com

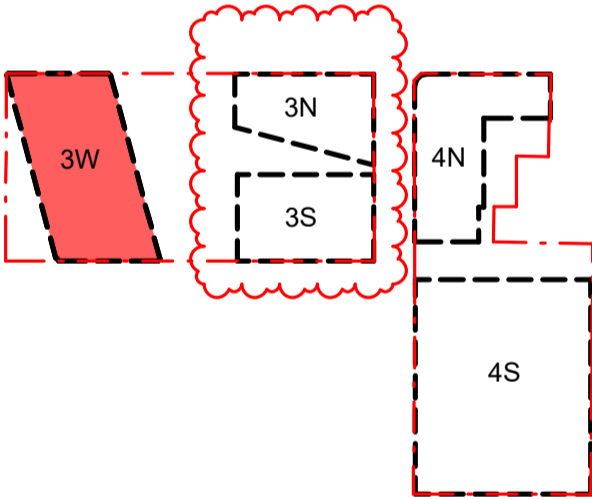

Client



Project

EAST END STAGE 3&4

Hunter, Morgan, Newcomen, King
Streets NEWCASTLE NSW 2300

Country: AWABAKAL

Drawing Name

FLOOR PLAN - 3W - LEVEL 01

Drawn

0 1 2 5m
1:100 @A1

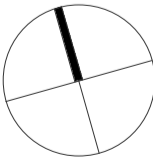

Date Scale Sheet Size

15.10.2024 1 : 100 @ A1

Drawn Chk. Revision

JG RY 6

Job No. Drawing No.

6668 DA-3W-1005

AWNING

RL 4.30

THORN STREET

1
DA-3W-1501

RL 5.05

BOUNDARY

RL 6.10

BOUNDARY

RL 6.40

LAING STREET

1
DA-3W-1402

RL 6.40

In accepting and utilising this document the recipient agrees that SJB Architecture (NSW) Pty. Ltd. ACN 081 094 724 T/A SJB Architects, retain all common law, statutory law and other rights including copyright and intellectual property rights. The recipient agrees not to use this document for any purpose other than its intended use; to waive all claims against SJB Architects resulting from unauthorised changes; or to reuse the document on other projects without prior written consent from SJB Architects. Under no circumstances shall transfer of this document be deemed a sale. SJB Architects makes no warranties of fitness for any purpose. The Builder/Contractor shall verify job dimensions prior to any work commencing. Use figured dimensions only. Do not scale drawings.

FOR APPROVAL

Rev	Date	Revision	By	Chk.
1	28.02.2023	FOR INFORMATION	JG	RY
2	08.03.2023	FOR INFORMATION	JG	RY
3	31.03.2023	ISSUE FOR DA	JG	RY
4	20.12.2023	ISSUE FOR COUNCIL	GS	RY
5	15.03.2024	COUNCIL RFI	JG	RY
6	15.10.2024	COUNCIL RFI	JG	WG

Precinct + Building 3W + 4S

SJB Architects
Level 2, 490 Crown St
Surry Hills NSW
2010 Australia
T 61 2 9380 9911
sjb.com.au



Building 3N + 3S

Durbach Block Jaggers
Level 2, 9 Roslyn St
Potts Point NSW
2011 Australia
T 61 2 8297 3500
durbachblockjaggers.com



Building 4N

Curious Practice
24/526 Hunter Street,
Newcastle NSW
2300 Australia
T 61 4 1182 4600
curiouspractice.com

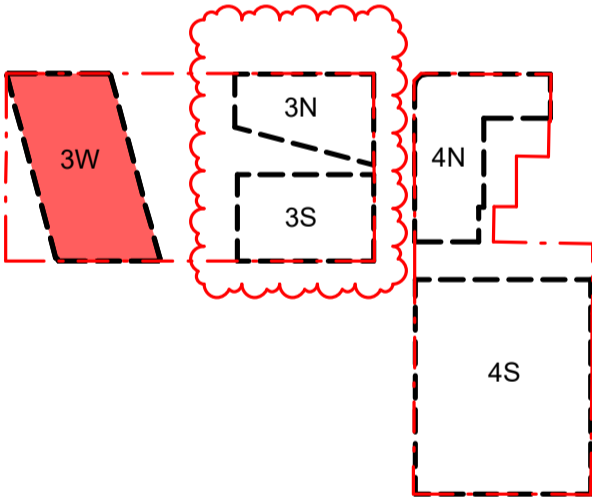

Client

iris

Project

EAST END STAGE 3&4

Hunter, Morgan, Newcomen, King
Streets NEWCASTLE NSW 2300

Country: AWABAKAL

Drawing Name

FLOOR PLAN - 3W - LEVEL 02

Drawn

0 1 2 5m
1:100 @A1

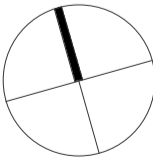

Date Scale Sheet Size

15.10.2024 1 : 100 @ A1

Drawn Chk. Revision

JG RY 6

Job No. Drawing No.

6668 DA-3W-1006



FOR APPROVAL

Rev	Date	Revision	By	Chk.
1	28.02.2023	FOR INFORMATION	JG	RY
2	08.03.2023	FOR INFORMATION	JG	RY
3	31.03.2023	ISSUE FOR DA	JG	RY
4	20.12.2023	ISSUE FOR COUNCIL	GS	RY
5	15.03.2024	COUNCIL RFI	JG	RY
6	15.10.2024	COUNCIL RFI	JG	WG

Precinct + Building 3W + 4S

SJB Architects
Level 2, 490 Crown St
Surry Hills NSW
2010 Australia
T 61 2 9380 9911
sjb.com.au



Building 3N + 3S

Durbach Block Jaggers
Level 2, 9 Roslyn St
Potts Point NSW
2011 Australia
T 61 2 8297 3500
durbachblockjaggers.com



Building 4N

Curious Practice
24/526 Hunter Street,
Newcastle NSW
2300 Australia
T 61 4 1182 4600
curiouspractice.com

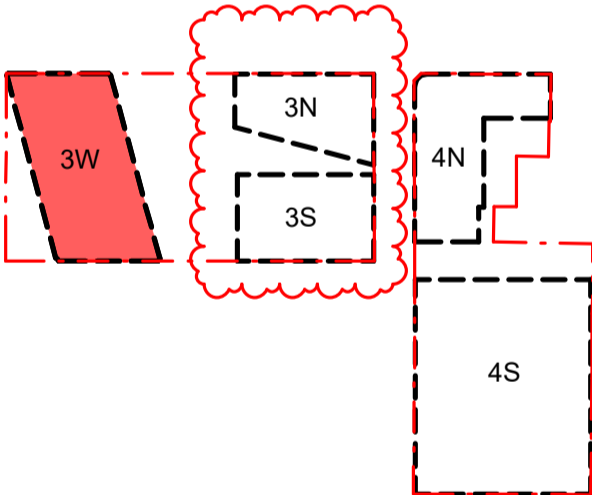

Client

iris

Project

EAST END STAGE 3&4

Hunter, Morgan, Newcomen, King
Streets NEWCASTLE NSW 2300

Country: AWABAKAL

Drawing Name

FLOOR PLAN - 3W - LEVEL 03

Drawn

0 1 2 5m
1:100 @A1

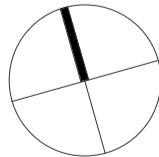

Date Scale Sheet Size

15.10.2024 1 : 100 @ A1

Drawn Chk. Revision

JG RY 6

Job No. Drawing No.

6668 DA-3W-1007



FOR APPROVAL

Rev	Date	Revision	By	Chk.
1	28.02.2023	FOR INFORMATION	JG	RY
2	08.03.2023	FOR INFORMATION	JG	RY
3	31.03.2023	ISSUE FOR DA	JG	RY
4	20.12.2023	ISSUE FOR COUNCIL	GS	RY
5	15.03.2024	COUNCIL RFI	JG	RY
6	15.10.2024	COUNCIL RFI	JG	WG

Precinct + Building 3W + 4S

SJB Architects
Level 2, 490 Crown St
Surry Hills NSW
2010 Australia
T 61 2 9380 9911
sjb.com.au



Building 3N + 3S

Durbach Block Jaggers
Level 2, 9 Roslyn St
Potts Point NSW
2011 Australia
T 61 2 8297 3500
durbachblockjaggers.com



Building 4N

Curious Practice
24/526 Hunter Street,
Newcastle NSW
2300 Australia
T 61 4 1182 4600
curiouspractice.com

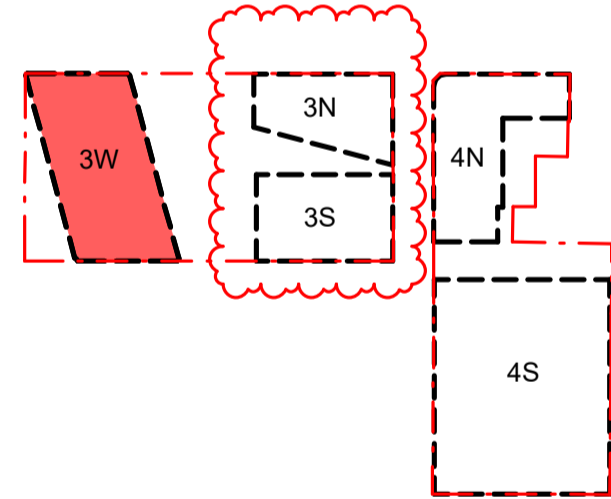

Client

iris

Project

EAST END STAGE 3&4

Hunter, Morgan, Newcomen, King
Streets NEWCASTLE NSW 2300

Country: AWABAKAL

Drawing Name

FLOOR PLAN - 3W - LEVEL 04

Drawn

0 1 2 5m
1:100 @A1

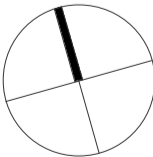

Date Scale Sheet Size

15.10.2024 1 : 100 @ A1

Drawn Chk. Revision

JG RY 6

Job No. Drawing No.

6668 DA-3W-1008



FOR APPROVAL

Rev	Date	Revision	By	Chk.
1	28.02.2023	FOR INFORMATION	JG	RY
2	08.03.2023	FOR INFORMATION	JG	RY
3	31.03.2023	ISSUE FOR DA	JG	RY
4	20.12.2023	ISSUE FOR COUNCIL	GS	RY
5	15.03.2024	COUNCIL RFI	JG	RY
6	15.10.2024	COUNCIL RFI	JG	WG

Precinct + Building 3W + 4S

SJB Architects
Level 2, 490 Crown St
Surry Hills NSW
2010 Australia
T 61 2 9380 9911
sjb.com.au



Building 3N + 3S

Durbach Block Jaggers
Level 2, 9 Roslyn St
Potts Point NSW
2011 Australia
T 61 2 8297 3500
durbachblockjaggers.com

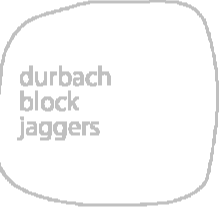

Building 4N

Curious Practice
24/526 Hunter Street,
Newcastle NSW
2300 Australia
T 61 4 1182 4600
curiouspractice.com

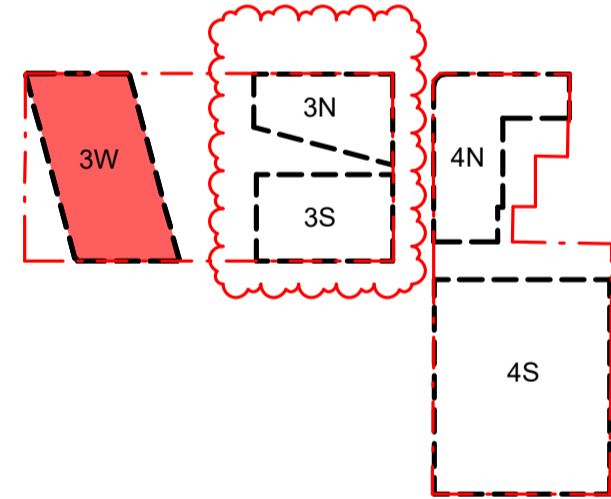

Client



Project

EAST END STAGE 3&4

Hunter, Morgan, Newcomen, King
Streets NEWCASTLE NSW 2300

Country: AWABAKAL

Drawing Name

FLOOR PLAN - 3W - LEVEL 05

Drawn

0 1 2 5m
1:100 @A1

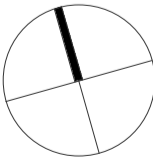

Date Scale Sheet Size

15.10.2024 1 : 100 @ A1

Drawn Chk. Revision

JG RY 6

Job No. Drawing No.

6668 DA-3W-1009



In accepting and utilising this document the recipient agrees that SJB Architects (NSW) Pty. Ltd. ACN 081 094 724 T/A SJB Architects, retain all common law, statutory law and other rights including copyright and intellectual property rights. The recipient agrees not to use this document for any purpose other than its intended use, to waive all claims against SJB Architects resulting from unauthorised changes, or to reuse the document on other projects without prior written consent from SJB Architects. Under no circumstances shall transfer of this document be deemed a sale. SJB Architects makes no warranties of fitness for any purpose. The Builder/Contractor shall verify job dimensions prior to any work commencing. Use figured dimensions only. Do not scale drawings.

FOR APPROVAL

Rev	Date	Revision	By	Chk.
1	28.02.2023	FOR INFORMATION	JG	RY
2	08.03.2023	FOR INFORMATION	JG	RY
3	31.03.2023	ISSUE FOR DA	JG	RY
4	20.12.2023	ISSUE FOR COUNCIL	GS	RY
5	15.03.2024	COUNCIL RFI	JG	RY
6	15.10.2024	COUNCIL RFI	JG	WG

Precinct + Building 3W + 4S

SJB Architects
Level 2, 490 Crown St
Surry Hills NSW
2010 Australia
T 61 2 9380 9911
sjb.com.au



Building 3N + 3S

Durbach Block Jaggers
Level 2, 9 Roslyn St
Potts Point NSW
2011 Australia
T 61 2 8297 3500
durbachblockjaggers.com

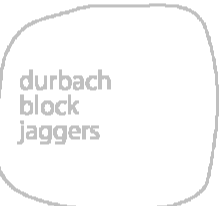

Building 4N

Curious Practice
24/526 Hunter Street,
Newcastle NSW
2300 Australia
T 61 4 1182 4600
curiouspractice.com

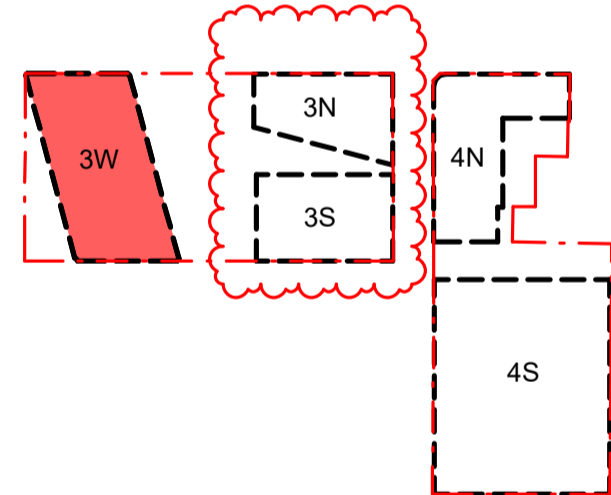

Client



Project

EAST END STAGE 3&4

Hunter, Morgan, Newcomen, King
Streets NEWCASTLE NSW 2300

Country: AWABAKAL

Drawing Name

FLOOR PLAN - 3W - LEVEL 06

Drawn

0 1 2 5m
1:100 @A1

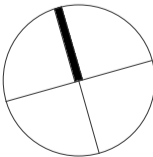

Date Scale Sheet Size

15.10.2024 1 : 100 @ A1

Drawn Chk. Revision

JG RY 6

Job No. Drawing No.

6668 DA-3W-1010



In accepting and utilising this document the recipient agrees that SJB Architecture (NSW) Pty. Ltd. ACN 081 094 724 T/A SJB Architects, retain all common law, statutory law and other rights including copyright and intellectual property rights. The recipient agrees not to use this document for any purpose other than its intended use, to waive all claims against SJB Architects resulting from unauthorised changes, or to reuse the document on other projects without prior written consent from SJB Architects. Under no circumstances shall transfer of this document be deemed a sale. SJB Architects makes no warranties of fitness for any purpose. The Builder/Contractor shall verify job dimensions prior to any work commencing. Use figured dimensions only. Do not scale drawings.

FOR APPROVAL

Rev	Date	Revision	By	Chk.
1	28.02.2023	FOR INFORMATION	JG	RY
2	08.03.2023	FOR INFORMATION	JG	RY
3	31.03.2023	ISSUE FOR DA	JG	RY
4	20.12.2023	ISSUE FOR COUNCIL	GS	RY
5	15.03.2024	COUNCIL RFI	SG	RY
6	15.10.2024	COUNCIL RFI	JG	WG

Precinct + Building 3W + 4S

SJB Architects
Level 2, 490 Crown St
Surry Hills NSW
2010 Australia
T 61 2 9380 9911
sjb.com.au



Building 3N & 3S

Durbach Block Jaggers
Level 2, 9 Roslyn St
Potts Point NSW
2011 Australia
T 61 2 8297 3500
durbachblockjaggers.com



Building 4N

Curious Practice
24/526 Hunter Street,
Newcastle NSW
2300 Australia
T 61 4 1182 4600
curiouspractice.com

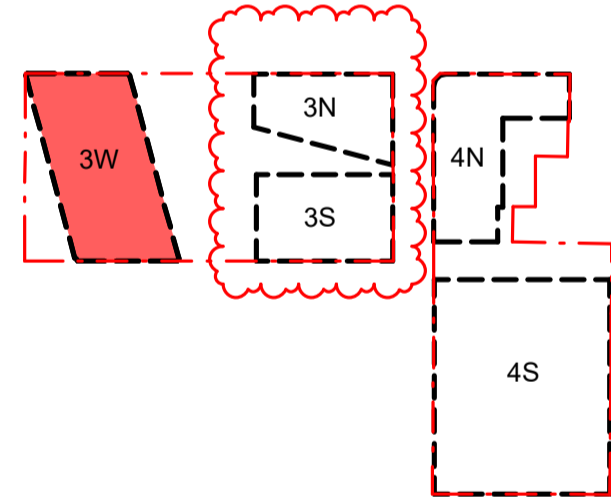

Client



Project

EAST END STAGE 3&4

Hunter, Morgan, Newcomen, King
Streets NEWCASTLE NSW 2300

Country: AWABAKAL

Drawing Name

FLOOR PLAN - 3W - LEVEL 07

Drawn

0 1 2 5m
1:100 @A1

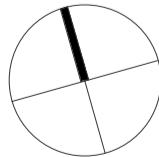

Date Scale Sheet Size

15.10.2024 1 : 100 @ A1

Drawn Chk. Revision

JG RY 6

Job No. Drawing No.

6668 DA-3W-1011



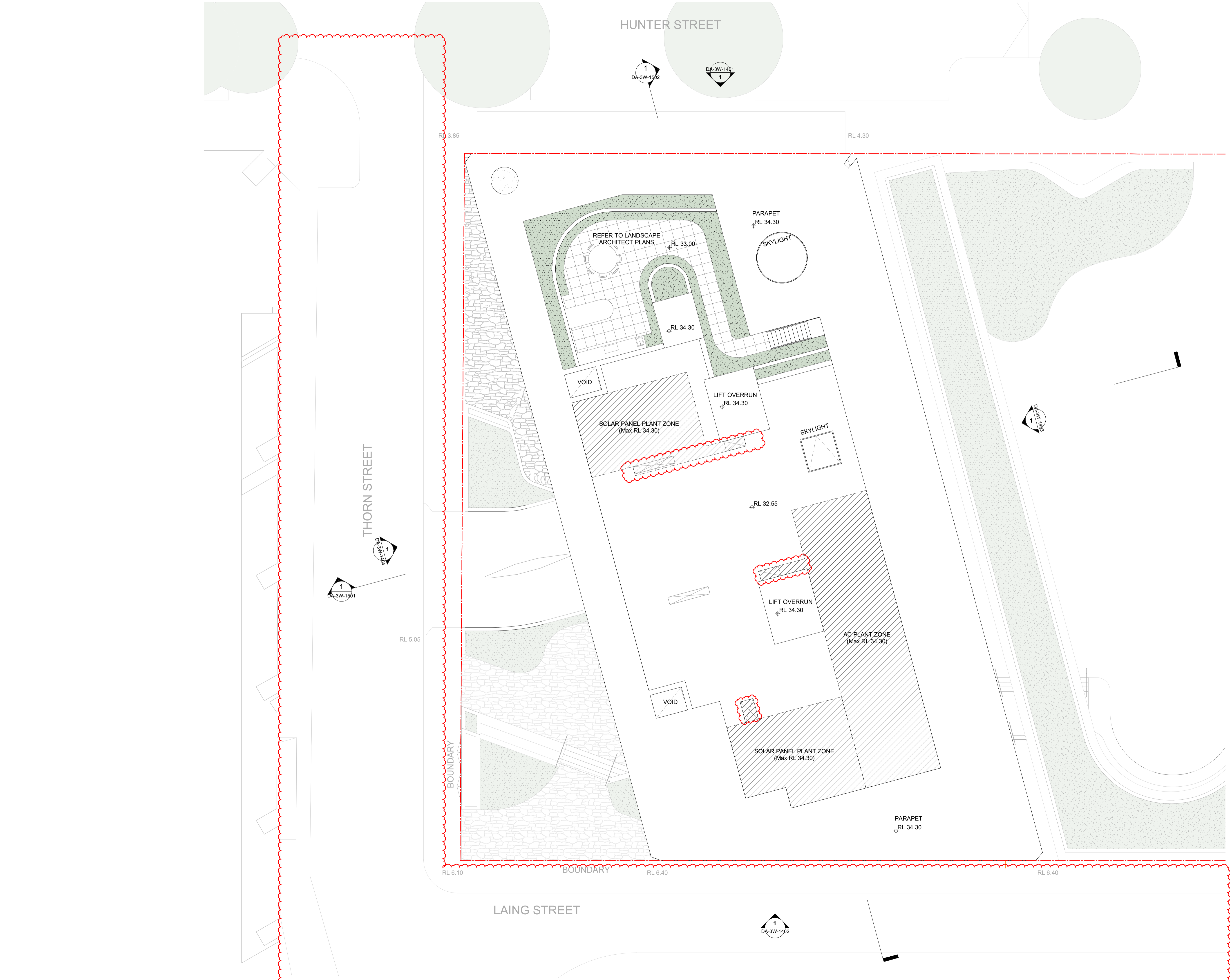

In accepting and utilising this document the recipient agrees that SJB Architecture (NSW) Pty. Ltd. ACN 081 094 724 T/A SJB Architects, retain all common law, statutory law and other rights including copyright and intellectual property rights. The recipient agrees not to use this document for any purpose other than its intended use; to waive all claims against SJB Architects resulting from unauthorised changes; or to reuse the document on other projects without prior written consent from SJB Architects. Under no circumstances shall transfer of this document be deemed a sale. SJB Architects makes no warranties of fitness for any purpose. The Builder/Contractor shall verify job dimensions prior to any work commencing. Use figured dimensions only. Do not scale drawings.

FOR APPROVAL

Rev	Date	Revision	By	Chk.
1	28.02.2023	FOR INFORMATION	JG	RY
2	08.03.2023	FOR INFORMATION	JG	RY
3	31.03.2023	ISSUE FOR DA	JG	RY
4	20.12.2023	ISSUE FOR COUNCIL	GS	RY
5	15.10.2024	COUNCIL RFI	JG	WG

Precinct + Building 3W + 4S

SJB Architects
Level 2, 490 Crown St
Surry Hills NSW
2010 Australia
T 61 2 9380 9911
sjb.com.au



Building 3N & 3S

Durbach Block Jaggers
Level 2, 9 Roslyn St
Potts Point NSW
2011 Australia
T 61 2 8297 3500
durbachblockjaggers.com

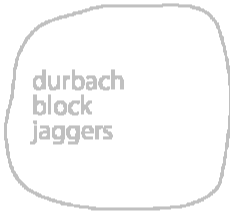

Building 4N

Curious Practice
24/526 Hunter Street,
Newcastle NSW
2300 Australia
T 61 4 1182 4600
curiouspractice.com

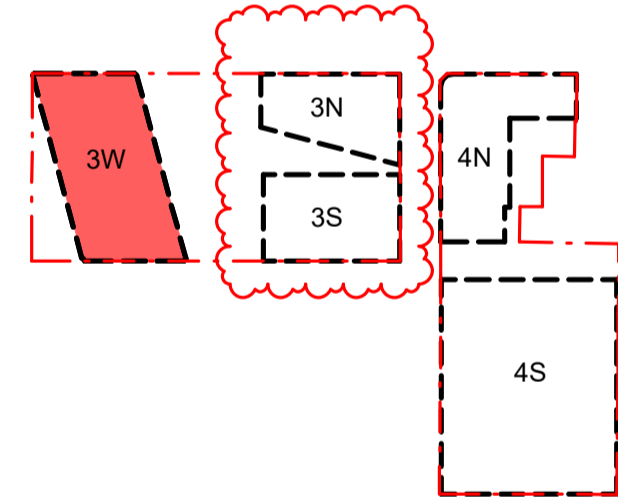

Client



Project

EAST END STAGE 3&4

Hunter, Morgan, Newcomen, King
Streets NEWCASTLE NSW 2300

Country: AWABAKAL

Drawing Name

FLOOR PLAN - 3W - ROOF

Drawn

0 1 2 5m
1:100 @A1

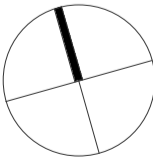

Date Scale Sheet Size

15.10.2024 1 : 100 @ A1

Drawn. Chk. Revision

JG RY 5

Job No. Drawing No.

6668 DA-3W-1012

In accepting and utilising this document the recipient agrees that SJB Architecture (NSW) Pty. Ltd. ACN 001 094 724 T/A SJB Architects, retain all common law, statutory law and other rights including copyright and intellectual property rights. The recipient agrees not to use this document for any purpose other than as intended use; to waive all claims against SJB Architects resulting from unauthorised changes; or to reuse the document on other projects without prior written consent from SJB Architects. Under no circumstances shall transfer of this document be deemed a sale. SJB Architects makes no warranty of fitness for any purpose. The Signed Contractor shall verify all dimensions prior to any work commencing. Use figured dimensions only! Do not scale drawings.

FOR APPROVAL

Rev	Date	Revision	By	Chk.
1	08.03.2023	FOR INFORMATION	JG	RY
2	08.03.2023	FOR INFORMATION	JG	RY
3	31.03.2023	ISSUE FOR DA	JG	RY
4	15.10.2024	COUNCIL RFI	JG	WG

Precinct + Building 3W + 4S

SJB Architects
Level 2, 490 Crown St
Surry Hills NSW
2010 Australia
T 61 2 9380 9911
sjb.com.au



Building 3N & 3S

Durbach Block Jaggers
Level 2, 9 Roslyn St
Potts Point NSW
2011 Australia
T 61 2 8297 3500
durbachblockjaggers.com

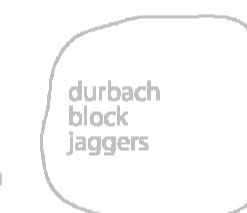

Building 4th

Curious Practice
24/526 Hunter Street,
Newcastle NSW
2300 Australia
T 61 4 1182 4600
curiouspractice.com

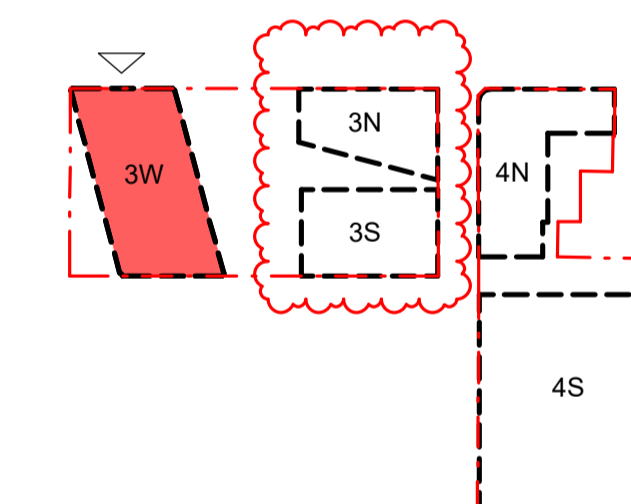

Client



Project

EAST END STAGE 3&4

Hunter, Morgan, Newcomen, King
Streets NEWCASTLE NSW 2300

Country: AWABAKAL

Drawing Name

ELEVATIONS - 3W - NORTH

Drawn

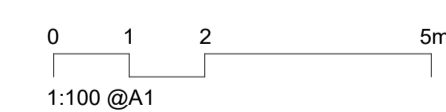

Date	Scale	Sheet Size
15.10.2024	1 : 100	@ A1

Drawn.	Chk.	Revision
JG	RY	4

Job No. _____ Drawing No. _____

6668

DA-3W-1401

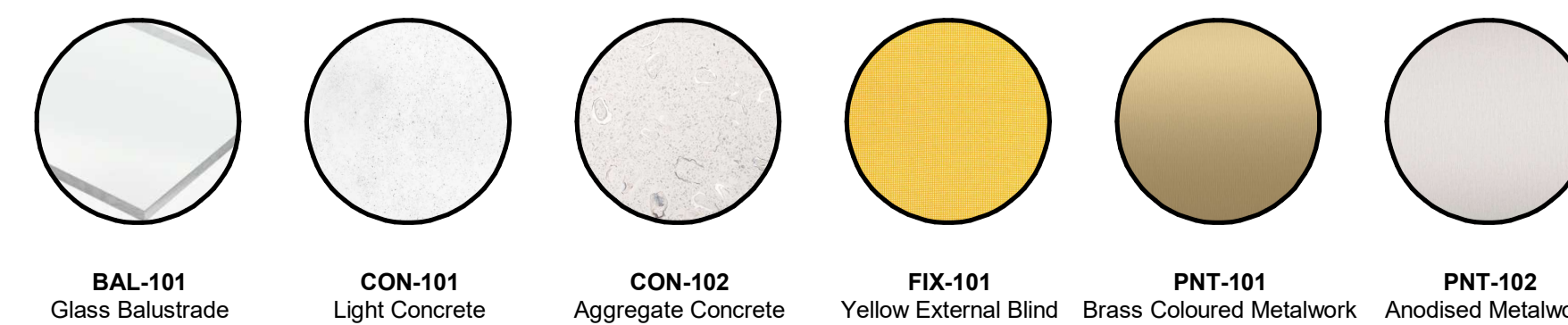

In accepting and utilising this document the recipient agrees that SJB Architecture (NSW) Pty. Ltd. ACN 081 094 724 T/A SJB Architects, retain all common law, statutory law and other rights including copyright and intellectual property rights. The recipient agrees not to use this document for any purpose other than its intended use, to waive all claims against SJB Architects resulting from unauthorised changes, or to reuse the document on other projects without prior written consent from SJB Architects. Under no circumstances shall transfer of this document be deemed a sale. SJB Architects makes no warranties of fitness for any purpose. The Builder/Contractor shall verify job dimensions prior to any work commencing. Use figured dimensions only. Do not scale drawings.

FOR APPROVAL

Rev	Date	Revision	By	Chk.
1	08.03.2023	FOR INFORMATION	JG	RY
2	08.03.2023	FOR INFORMATION	JG	RY
3	31.03.2023	ISSUE FOR DA	JG	RY
4	15.10.2024	COUNCIL RFI	JG	WG

Precinct + Building 3W + 4S

SJB Architects
Level 2, 490 Crown St
Surry Hills NSW
2010 Australia
T 61 2 9380 9911
sjb.com.au



Building 3N & 3S

Durbach Block Jaggers
Level 2, 9 Roslyn St
Potts Point NSW
2011 Australia
T 61 2 8297 3500
durbachblockjaggers.com



Building 4N

Curious Practice
24/526 Hunter Street,
Newcastle NSW
2300 Australia
T 61 4 1182 4600
curiouspractice.com

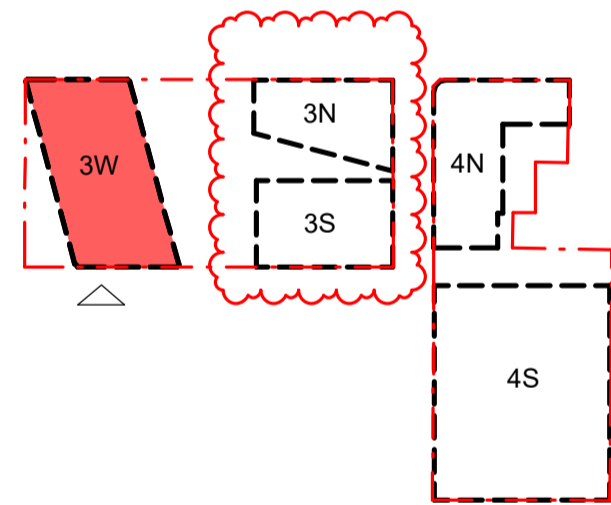

Client



Project

EAST END STAGE 3&4

Hunter, Morgan, Newcomen, King
Streets NEWCASTLE NSW 2300

Country: AWABAKAL

Drawing Name

ELEVATIONS - 3W - SOUTH

Drawn

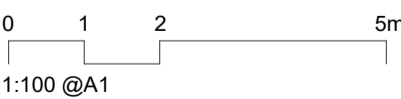

Date	Scale	Sheet Size
15.10.2024	1 : 100	@ A1
Drawn	Chk.	Revision
JG	RY	4
Job No.	Drawing No.	

6668

DA-3W-1402

FOR APPROVAL

Precinct + Building 3W + 4S
sjb Architects
 Level 2, 490 Crown St
 Surry Hills NSW
 2010 Australia
 T 61 2 9380 9911
sjb.com.au

durbach
block
jaggers

CURIOUS
PRACTICE

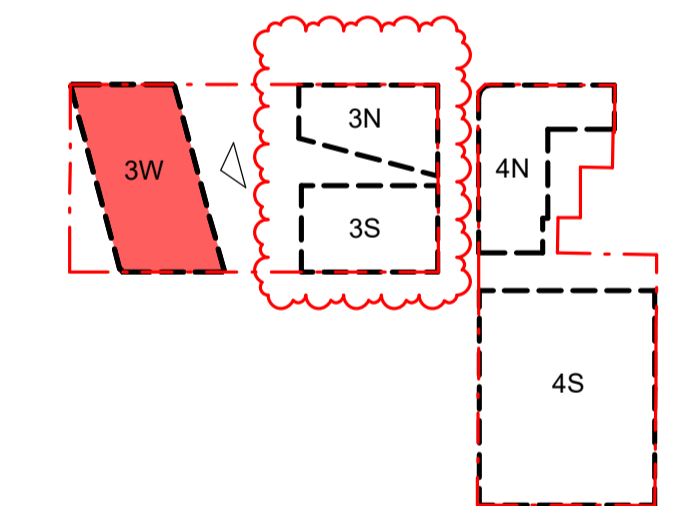

iris

EAST END STAGE 3&4

Country: AWABAKAL

ELEVATIONS - 3W - EAST

0 1 2 5m
1:100 @ A1

Job No.	Drawing No.
---------	-------------

6668 DA-3W-1403

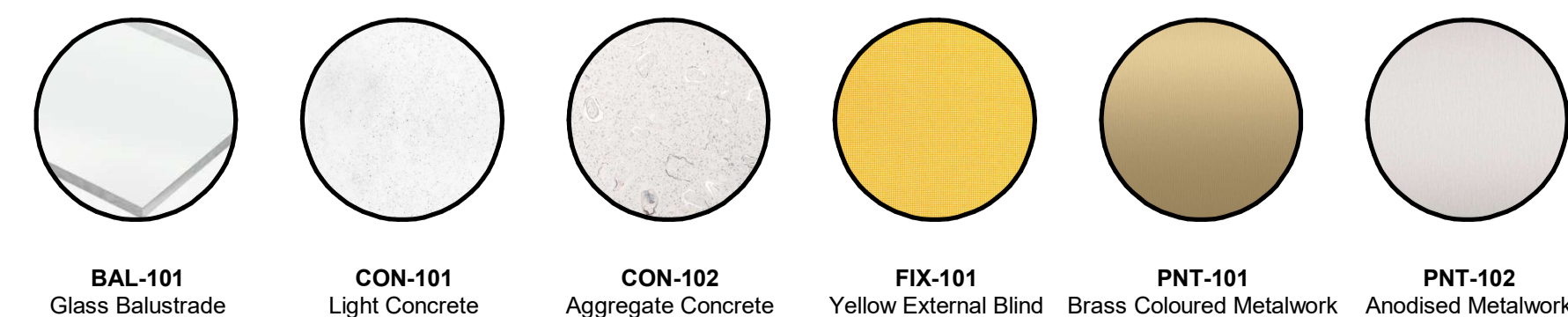

FOR APPROVAL

Precinct + Building 3W + 4S
sjb Architects
 Level 2, 490 Crown St
 Surry Hills NSW
 2010 Australia
 T 61 2 9380 9911
sjb.com.au



durbach
block
jaggers

CURIOUS
PRACTICE

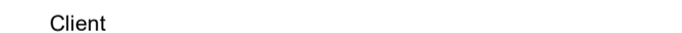

Project

Hunter, Morgan, Newcomen, King
Streets NEWCASTLE NSW 2300

Drawing Name

Drawn



JG RY 4

Job No. _____ Drawing No. _____

6668 DA-3W-1404



In accepting and utilising this document the recipient agrees that SJB Architecture (NSW) Pty. Ltd. ACN 081 094 724 T/A SJB Architects, retain all common law, statutory law and other rights including copyright and intellectual property rights. The recipient agrees not to use this document for any purpose other than its intended use, to waive all claims against SJB Architects resulting from unauthorised changes, or to reuse the document on other projects without prior written consent from SJB Architects. Under no circumstances shall transfer of this document be deemed a sale. SJB Architects makes no warranties of fitness for any purpose. The Builder/Contractor shall verify job dimensions prior to any work commencing. Use figured dimensions only. Do not scale drawings.

FOR APPROVAL

Rev	Date	Revision	By	Chk.
1	08.03.2023	FOR INFORMATION	JG	RY
2	31.03.2023	ISSUE FOR DA	JG	RY
3	07.12.2023	COUNCIL RFI RESPONSE	SG	RY
4	20.12.2023	ISSUE FOR COUNCIL	GS	RY
5	15.10.2024	COUNCIL RFI	JG	WG

Precinct + Building 3W + 4S

SJB Architects
Level 2, 490 Crown St
Surry Hills NSW
2010 Australia
T 61 2 9380 9911
sjb.com.au



Building 3N & 3S

Durbach Block Jaggers
Level 2, 9 Roslyn St
Potts Point NSW
2011 Australia
T 61 2 8297 3500
durbachblockjaggers.com

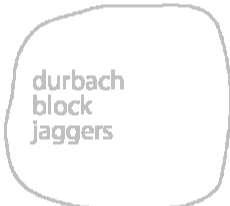

Building 4N

Curious Practice
24/526 Hunter Street,
Newcastle NSW
2300 Australia
T 61 4 1182 4600
curiouspractice.com

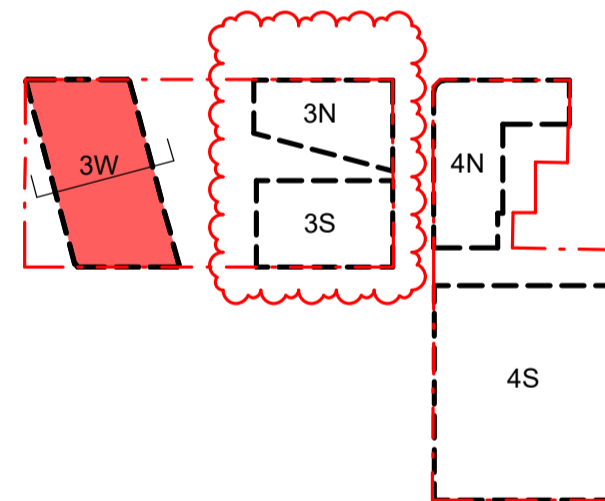

Client



Project

EAST END STAGE 3&4

Hunter, Morgan, Newcomen, King
Streets NEWCASTLE NSW 2300

Country: AWABAKAL

Drawing Name

SECTIONS - 3W - BUILDING
SECTION A

Drawn

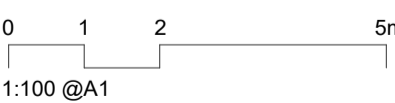

Date Scale Sheet Size

15.10.2024 1 : 100 @ A1

Drawn. Chk. Revision

JG RY 5

Job No. Drawing No.

6668 DA-3W-1501

In accepting and utilising this document the recipient agrees that SJB Architecture (NSW) Pty Ltd, ACN 081 094 724 T/A SJB Architects, retain all common law, statutory law and other rights including copyright and intellectual property rights. The recipient agrees not to use this document for any purpose other than its intended use, to waive all claims against SJB Architects resulting from unauthorised changes, or to reuse the document on other projects without prior written consent from SJB Architects. Under no circumstances shall transfer of this document be deemed a sale. SJB Architects makes no warranties of fitness for any purpose. The Builder/Contractor shall verify job dimensions prior to any work commencing. Use figured dimensions only. Do not scale drawings.

FOR APPROVAL

Rev	Date	Revision	By	Chk.
1	08.03.2023	FOR INFORMATION	JG	RY
2	31.03.2023	ISSUE FOR DA	JG	RY
3	07.12.2023	COUNCIL RFI RESPONSE	SG	RY
4	20.12.2023	ISSUE FOR COUNCIL	GS	RY
5	15.10.2024	COUNCIL RFI	JG	WG

Precinct + Building 3W + 4S

SJB Architects
Level 2, 490 Crown St
Surry Hills NSW
2010 Australia
T 61 2 9380 9911
sjb.com.au



Building 3N & 3S

Durbach Block Jaggers
Level 2, 9 Roslyn St
Potts Point NSW
2011 Australia
T 61 2 8297 3500
durbachblockjaggers.com

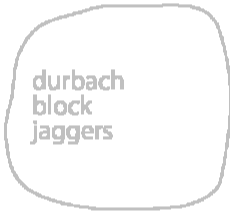

Building 4N

Curious Practice
24/526 Hunter Street,
Newcastle NSW
2300 Australia
T 61 4 1182 4600
curiouspractice.com

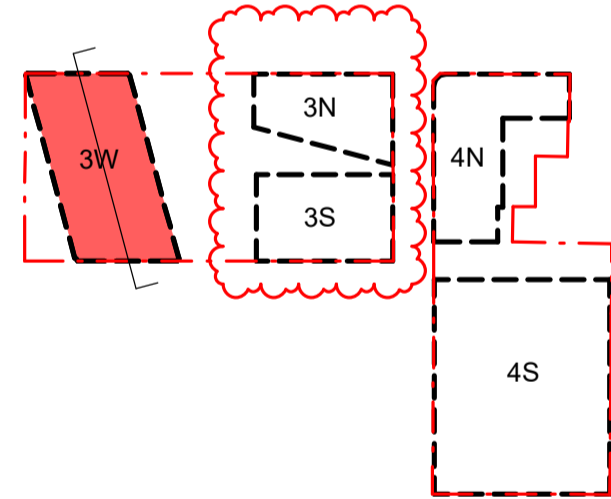

Client



Project

EAST END STAGE 3&4

Hunter, Morgan, Newcomen, King
Streets NEWCASTLE NSW 2300

Country: AWABAKAL

Drawing Name

**SECTIONS - 3W - BUILDING
SECTION B**

Drawn

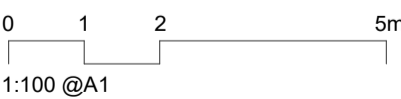

Date Scale Sheet Size

15.10.2024 1 : 100 @ A1

Drawn Chk. Revision

JG RY 5

Job No. Drawing No.

6668 DA-3W-1502

In accepting and utilising this document the recipient agrees that SJB Architecture (NSW) Pty. Ltd. ACN 001 094 724 T/A SJB Architects, retain all common law, statutory law and other rights including copyright and intellectual property rights. The recipient agrees not to use this document for any purpose other than as intended use; to waive all claims against SJB Architects resulting from unauthorised changes; or to reuse the document on other projects without prior written consent from SJB Architects. Under no circumstances shall transfer of this document be deemed a sale. SJB Architects makes no warranty of fitness for any purpose. The Signed Contractor shall verify all dimensions prior to any work commencing. Use figured dimensions only! Do not scale drawings.

FOR APPROVAL

Rev	Date	Revision	By	Chk.
1	08.03.2023	FOR INFORMATION	JG	RY
2	31.03.2023	ISSUE FOR DA	JG	RY
3	15.10.2024	COUNCIL RFI	JG	WG

Precinct + Building 3W + 4S

SJB Architects
Level 2, 490 Crown St
Surry Hills NSW
2010 Australia
T 61 2 9380 9911
sjb.com.au



Building 3N & 3S

Durbach Block Jaggers
Level 2, 9 Roslyn St
Potts Point NSW
2011 Australia
T 61 2 8297 3500
durbachblockjaggers.com

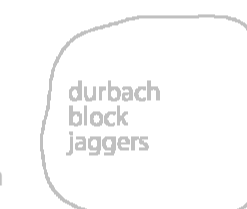

Building 4th

Curious Practice
24/526 Hunter Street,
Newcastle NSW
2300 Australia
T 61 4 1182 4600
curiouspractice.com



Client

iris

Project

EAST END STAGE 3&4

Hunter, Morgan, Newcomen, King
Streets NEWCASTLE NSW 2300

Country: AWABAKAL

Drawing Name

ADAPTABLE APARTMENT - 3W
06.02

Drawn

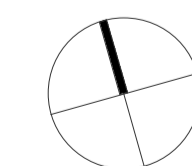
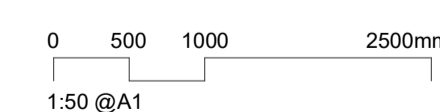

Date _____ Scale _____ Sheet Size _____

Date	Scale	Sheet Size
15.10.2024	1 : 50	@ A1

Drawn.	Chk.	Revision
--------	------	----------

JG RY 3

Job No.	Drawing No.
---------	-------------

6668 DA-3W-4052

DA-3W-4052

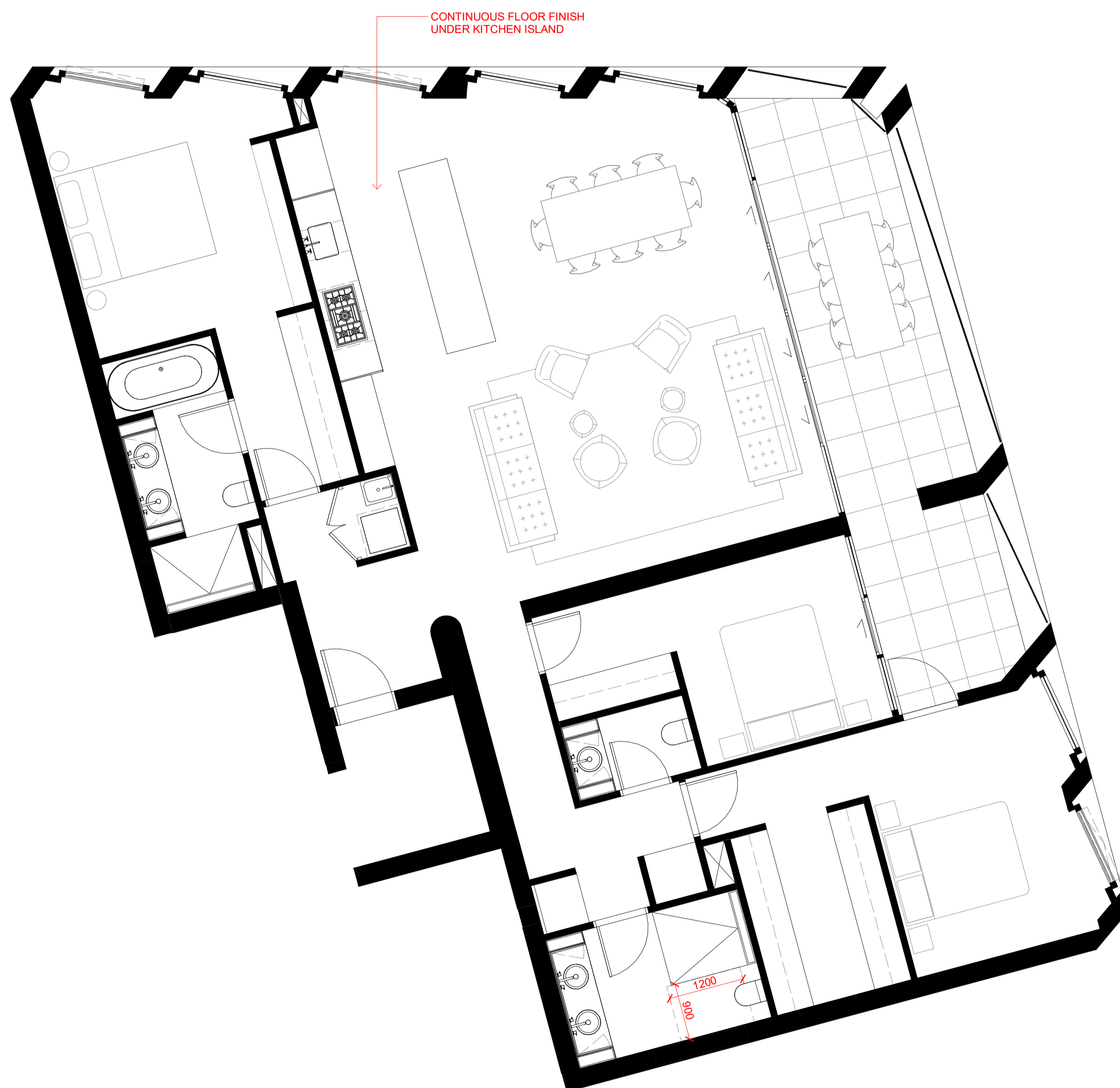

2 PLAN
3W-APARTMENT 06.02 PRE-ADAPT

SCALE 1 : 50

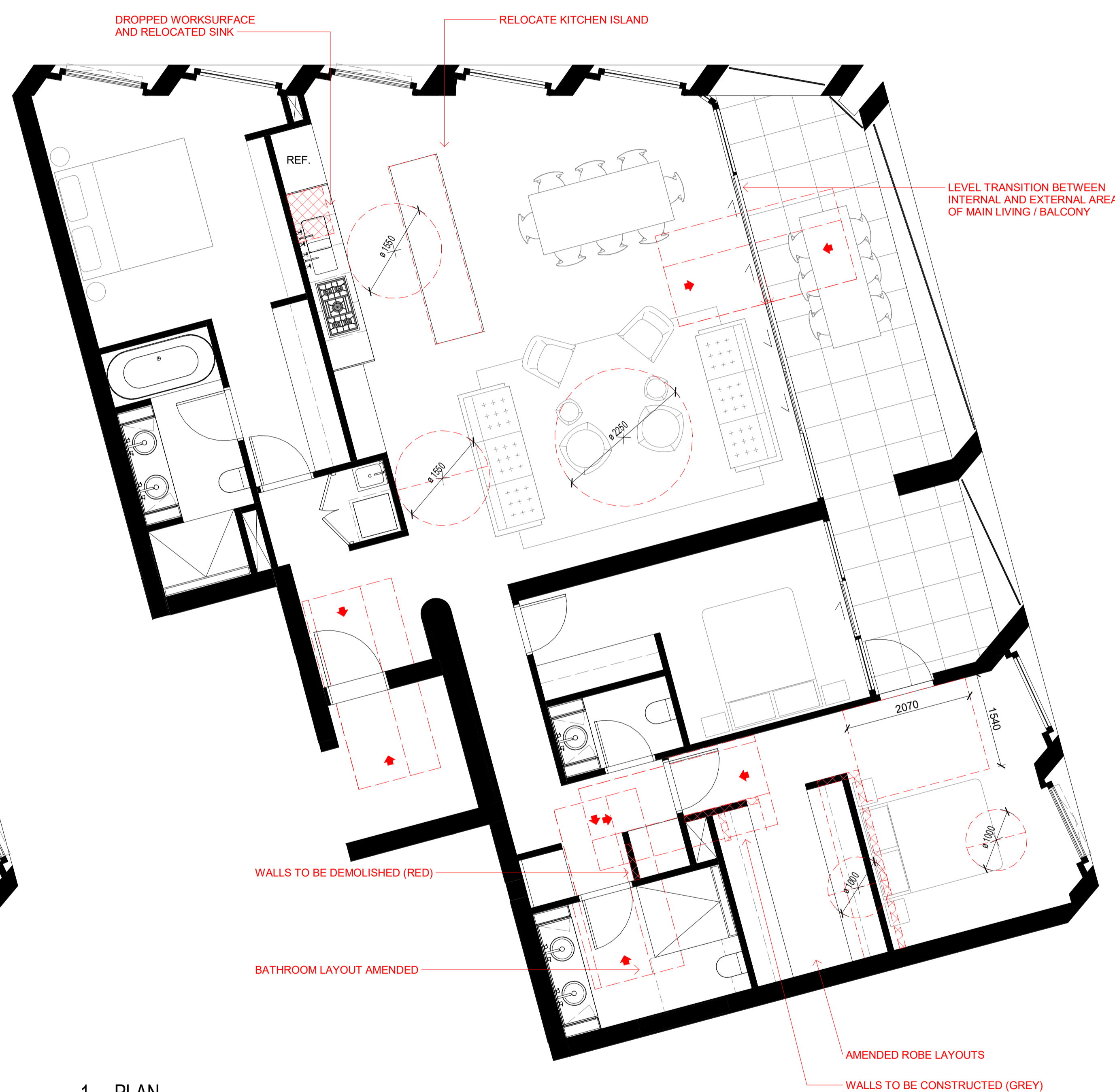

1 PLAN
3W-APARTMENT 06.02 POST ADAPT

SCALE 1 : 50

In accepting and utilising this document the recipient agrees that SJB Architecture (NSW) Pty. Ltd. ACN 081 094 724 T/A SJB Architects, retain all common law, statutory law and other rights including copyright and intellectual property rights. The recipient agrees not to use this document for any purpose other than its intended use, to waive all claims against SJB Architects resulting from unauthorised changes, or to reuse the document on other projects without prior written consent from SJB Architects. Under no circumstances shall transfer of this document be deemed a sale. SJB Architects makes no warranties of fitness for any purpose. The Builder/Contractor shall verify job dimensions prior to any work commencing. Use figured dimensions only. Do not scale drawings.

FOR APPROVAL

Rev	Date	Revision	By	Chk.
1	08.03.2023	FOR INFORMATION	JG	RY
2	31.03.2023	ISSUE FOR DA	JG	RY
3	15.10.2024	COUNCIL RFI	JG	WG

Precinct + Building 3W + 4S

SJB Architects
Level 2, 490 Crown St
Surry Hills NSW
2010 Australia
T 61 2 9380 9911
sjb.com.au



Building 3N & 3S

Durbach Block Jaggers
Level 2, 9 Roslyn St
Potts Point NSW
2011 Australia
T 61 2 8297 3500
durbachblockjaggers.com

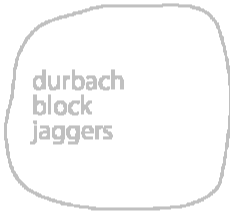

Building 4N

Curious Practice
24/526 Hunter Street,
Newcastle NSW
2300 Australia
T 61 4 1182 4600
curiouspractice.com



Client

iris

Project

EAST END STAGE 3&4

Hunter, Morgan, Newcomen, King
Streets NEWCASTLE NSW 2300

Country: AWABAKAL

Drawing Name

ADAPTABLE APARTMENT - 3W
07.01

Drawn

0 750 1500 3750mm
1:75 @A1

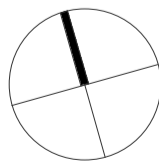

Date Scale Sheet Size

15.10.2024 1 : 75 @ A1

Drawn. Chk. Revision

JG RY 3

Job No. Drawing No.

6668 DA-3W-4053

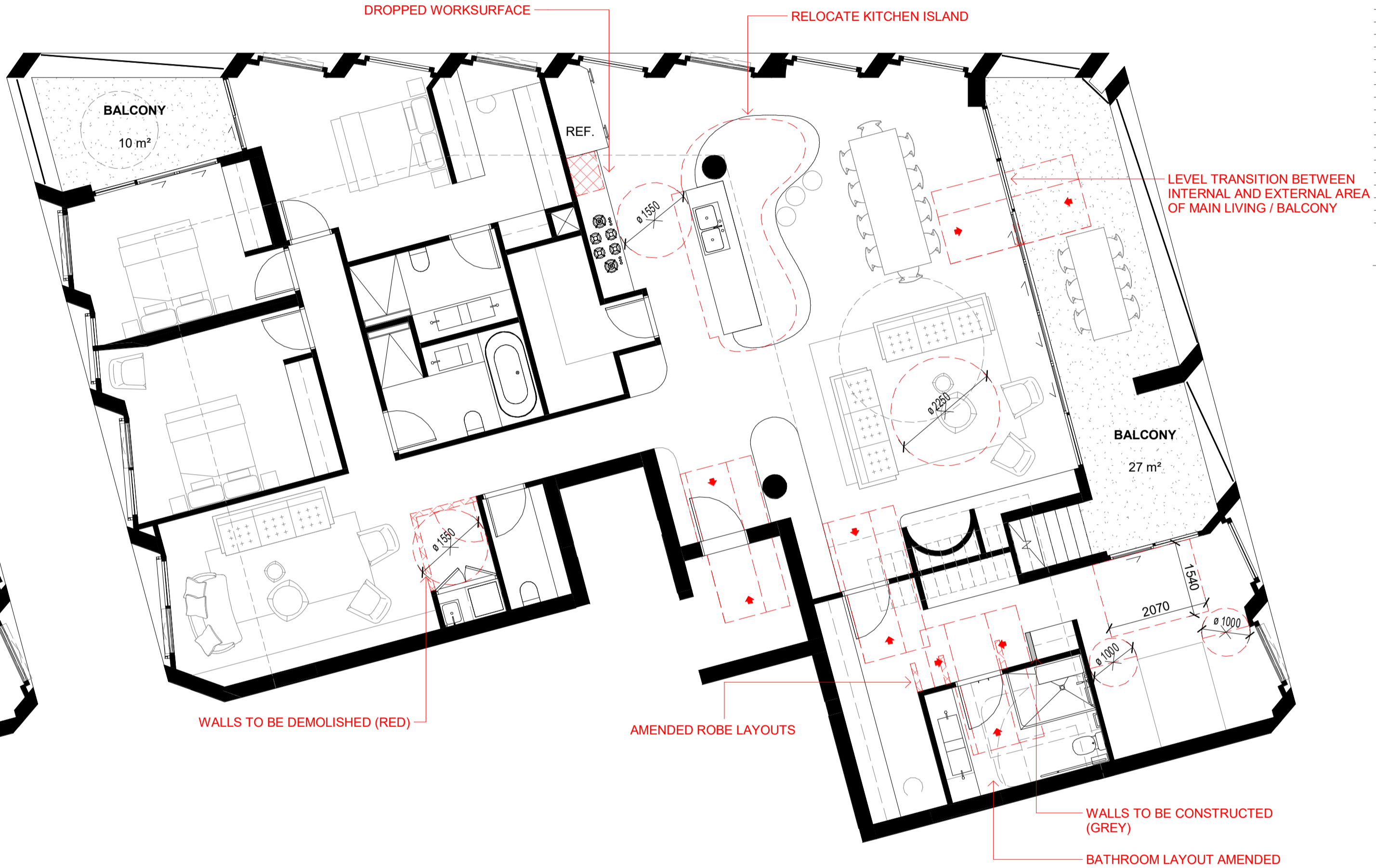
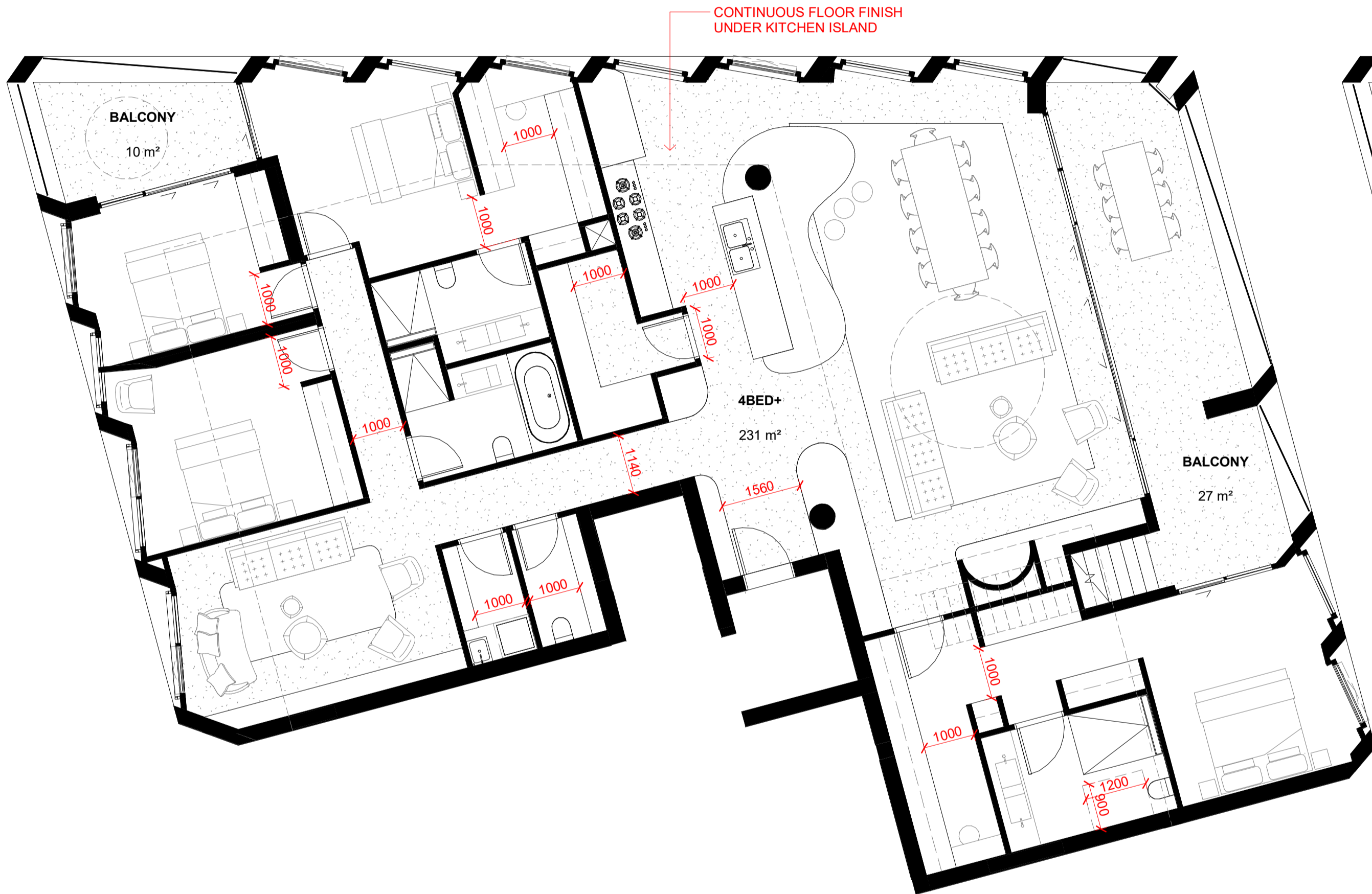

1
DA-3W-1401

3W-APARTMENT 07.01 PRE-ADAPT
1 : 75@A1

2
DA-3W-1401

3W-APARTMENT 07.01 POST ADAPT
1 : 75@A1

In accepting and utilising this document the recipient agrees that SJB Architecture (NSW) Pty. Ltd. ACN 081 094 724 T/A SJB Architects, retain all common law, statutory law and other rights including copyright and intellectual property rights. The recipient agrees not to use this document for any purpose other than its intended use, to waive all claims against SJB Architects resulting from unauthorised changes, or to reuse the document on other projects without prior written consent from SJB Architects. Under no circumstances shall transfer of this document be deemed a sale. SJB Architects makes no warranties of fitness for any purpose. The Builder/Contractor shall verify job dimensions prior to any work commencing. Use figured dimensions only. Do not scale drawings.

FOR APPROVAL

Rev	Date	Revision	By	Chk.
1	08.03.2023	FOR INFORMATION	JG	RY
2	31.03.2023	ISSUE FOR DA	JG	RY
3	20.12.2023	ISSUE FOR COUNCIL	GS	RY
4	15.10.2024	COUNCIL RFI	JG	WG

Precinct + Building 3W + 4S

SJB Architects
Level 2, 490 Crown St
Surry Hills NSW
2010 Australia
T 61 2 9380 9911
sjb.com.au



Building 3N & 3S

Durbach Block Jaggers
Level 2, 9 Roslyn St
Potts Point NSW
2011 Australia
T 61 2 8297 3500
durbachblockjaggers.com



Building 4N

Curious Practice
24/526 Hunter Street,
Newcastle NSW
2300 Australia
T 61 4 1182 4600
curiouspractice.com



Client



Project

EAST END STAGE 3&4

Hunter, Morgan, Newcomen, King
Streets NEWCASTLE NSW 2300

Country: AWABAKAL

Drawing Name

**ADAPTABLE APARTMENT - 3W
07.05**

Drawn

0 500 1000 2500mm
1:50 @A1

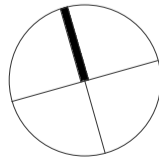

Date Scale Sheet Size

15.10.2024 1 : 50 @ A1

Drawn Chk. Revision

JG RY 4

Job No. Drawing No.

6668 DA-3W-4054

2
DA-3W-1401

3W-APARTMENT 07.05 POST ADAPT
1 : 50@A1

1
DA-3W-1401

3W-APARTMENT 07.05 PRE-ADAPT
1 : 50@A1



In accepting and utilising this document the recipient agrees that SJB Architecture (NSW) Pty. Ltd. ACN 081 094 724 T/A SJB Architects, retain all common law, statutory law and other rights including copyright and intellectual property rights. The recipient agrees not to use this document for any purpose other than as intended use; to waive all claims against SJB Architects resulting from unauthorised changes; or to reuse the document on other projects without prior written consent from SJB Architects. Under no circumstances shall transfer of this document be deemed a sale. SJB Architects makes no warranty of fitness for any purpose. The SJB Architect/Contractor shall verify all dimensions prior to any work commencing. Use figured dimensions only! Do not scale drawings.

FOR APPROVAL

Rev	Date	Revision	By	Chk.
1	08.03.2023	FOR INFORMATION	JG	RY
2	31.03.2023	ISSUE FOR DA	JG	RY
3	20.12.2023	ISSUE FOR COUNCIL	GS	RY
4	15.10.2024	COUNCIL RFI	JG	WG

[illegible]

Precinct + Building 3W + 4S

SJB Architects
Level 2, 490 Crown St
Surry Hills NSW
2010 Australia
T 61 2 9380 9911
sjb.com.au



Building 3N & 3S

Durbach Block Jaggers
Level 2, 9 Roslyn St
Potts Point NSW
2011 Australia
T 61 2 8297 3500
durbachblockjaggers.com

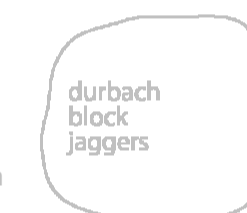

Building 4N

Curious Practice
24/526 Hunter Street,
Newcastle NSW
2300 Australia
T 61 4 1182 4600
curiouspractice.com

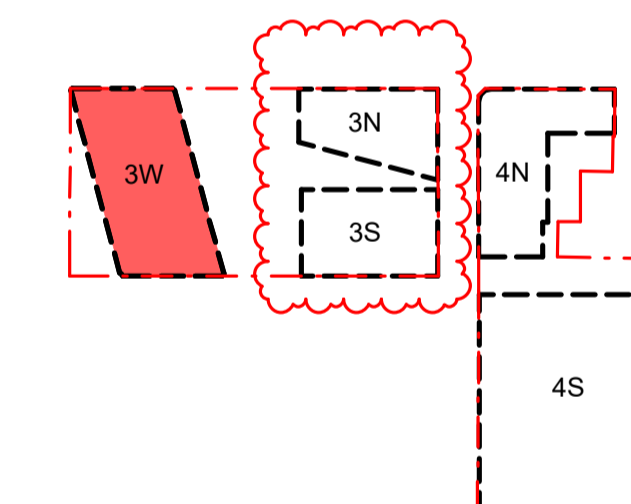

Client



Project

EAST END STAGE 3&4

Hunter, Morgan, Newcomen, King
Streets NEWCASTLE NSW 2300

Country: AWABAKAL

Drawing Name

COMPLIANCE DIAGRAMS - 3W
- SOLAR

Drawn

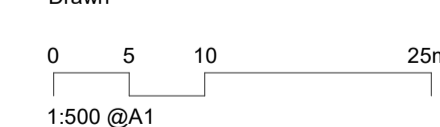

Date	Scale	Sheet Size
15.10.2024	As indicated	@ A1

Drawn.	Chk.	Revision
JG	RY	4

Job No. _____ Drawing No. _____

6668	DA-3W-8001
------	------------

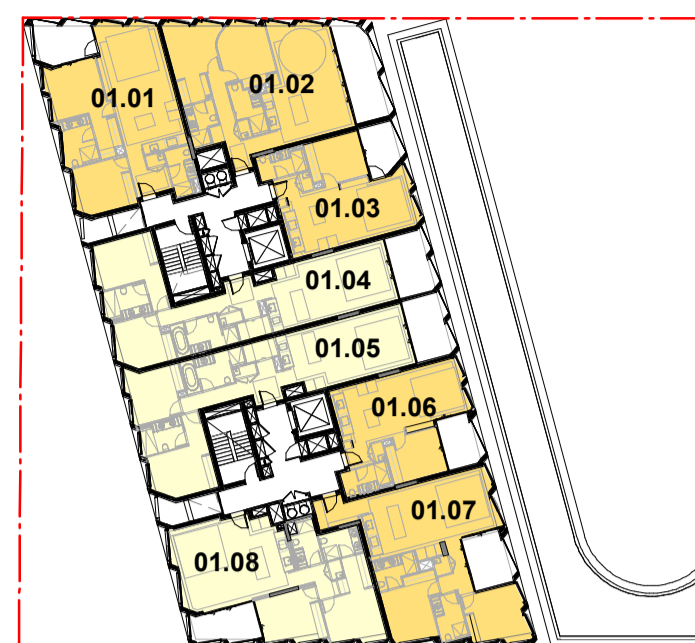

SOLAR_LEVEL 01

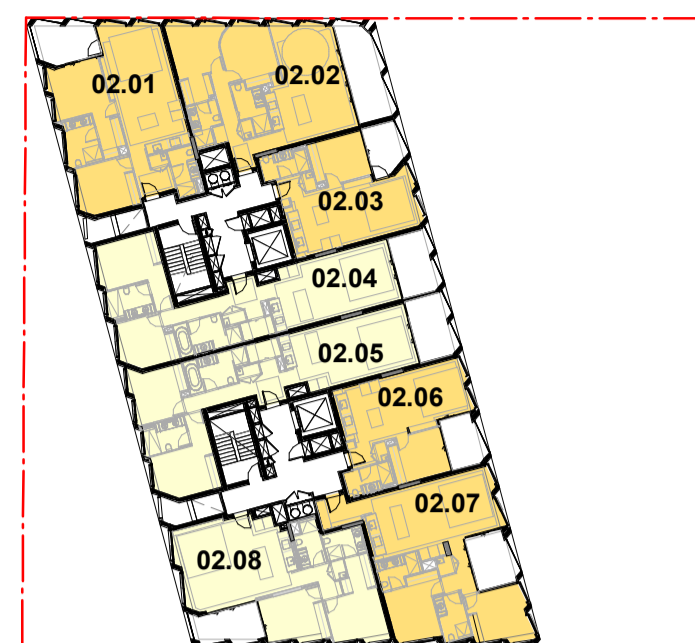

SOLAR_LEVEL 02

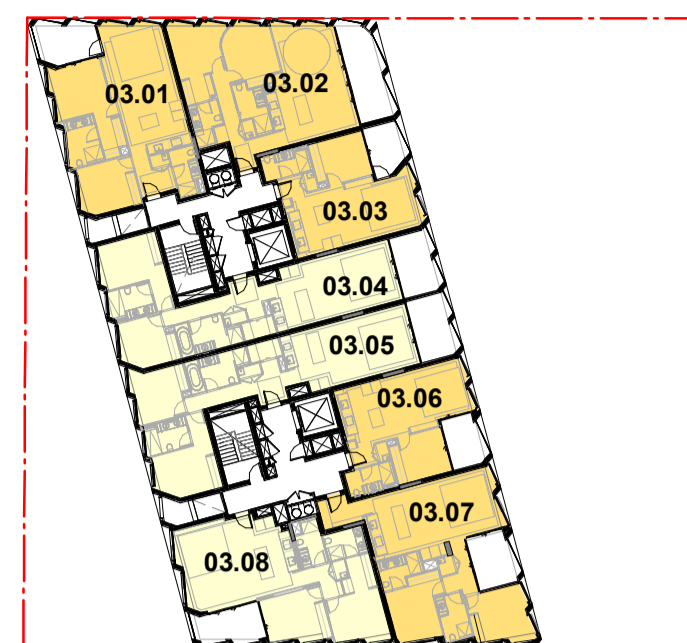

SOLAR_LEVEL 03

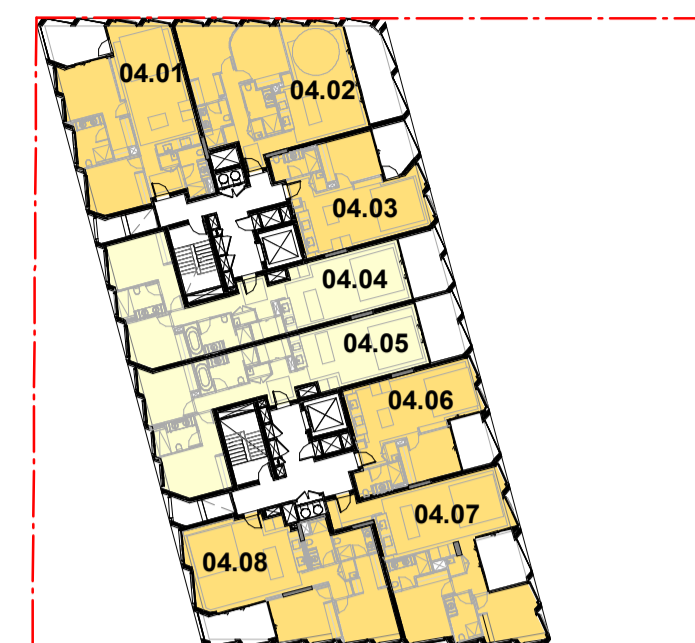

SOLAR_LEVEL 04

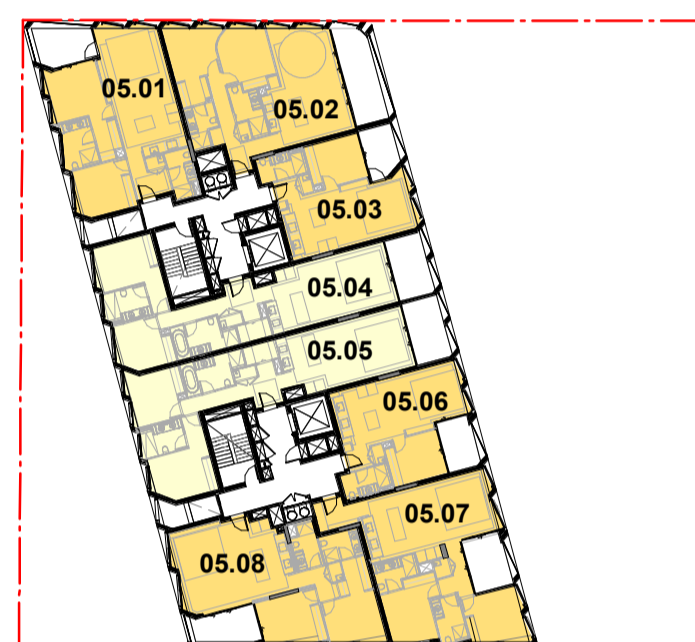

SOLAR_LEVEL 05

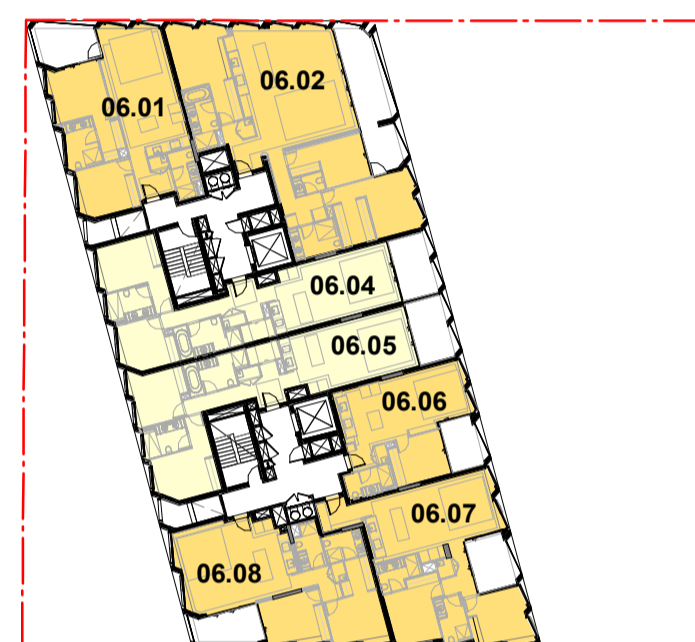

SOLAR_LEVEL 06

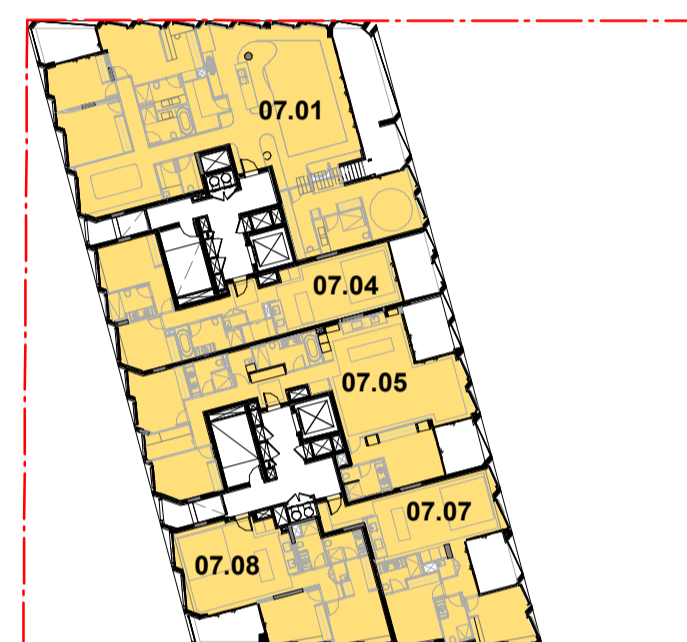

SOLAR_LEVEL 07

SOLAR SUMMARY

71% (37/52) OF RESIDENTIAL UNITS RECEIVE A MINIMUM OF 2 HOURS OF SUNLIGHT TO LIVING ROOM AND PRIVATE OPEN SPACES

LEGEND

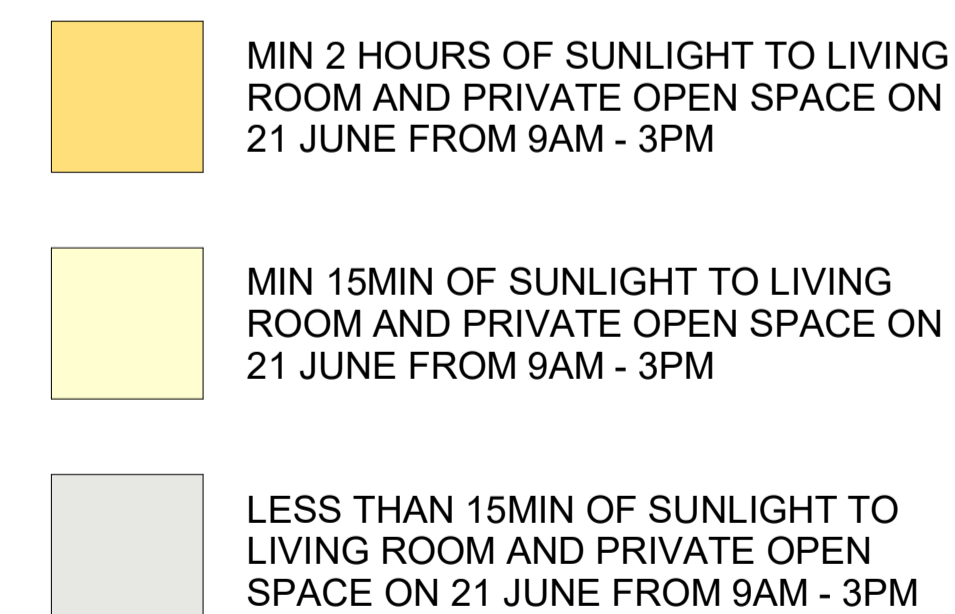

ADG DESIGN CRITERIA

LIVING ROOMS AND PRIVATE OPEN SPACES OF AT LEAST 70% OF APARTMENTS IN A BUILDING RECEIVE A MINIMUM OF 2 HOURS DIRECT SUNLIGHT BETWEEN 9AM AND 3PM IN MID WINTER

In accepting and utilising this document the recipient agrees that SJB Architecture (NSW) Pty. Ltd. ACN 081 094 724 T/A SJB Architects, retain all common law, statutory law and other rights including copyright and intellectual property rights. The recipient agrees not to use this document for any purpose other than its intended use; to waive all claims against SJB Architects resulting from unauthorised changes; or to reuse the document on other projects without prior written consent from SJB Architects. Under no circumstances shall transfer of this document be deemed a sale. SJB Architects makes no warranties of fitness for any purpose. The Builder/Contractor shall verify job dimensions prior to any work commencing. Use figured dimensions only. Do not scale drawings.



CROSS VENT_LEVEL 01

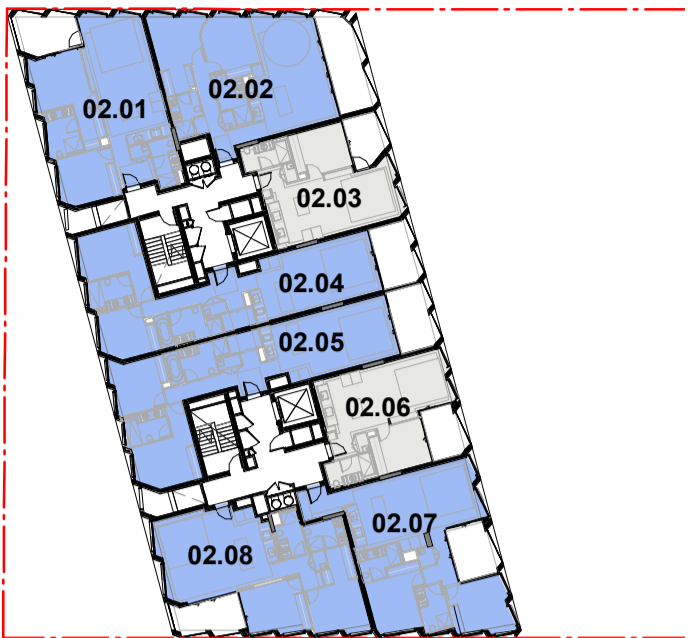

CROSS VENT_LEVEL 02



CROSS VENT_LEVEL 03



CROSS VENT_LEVEL 04

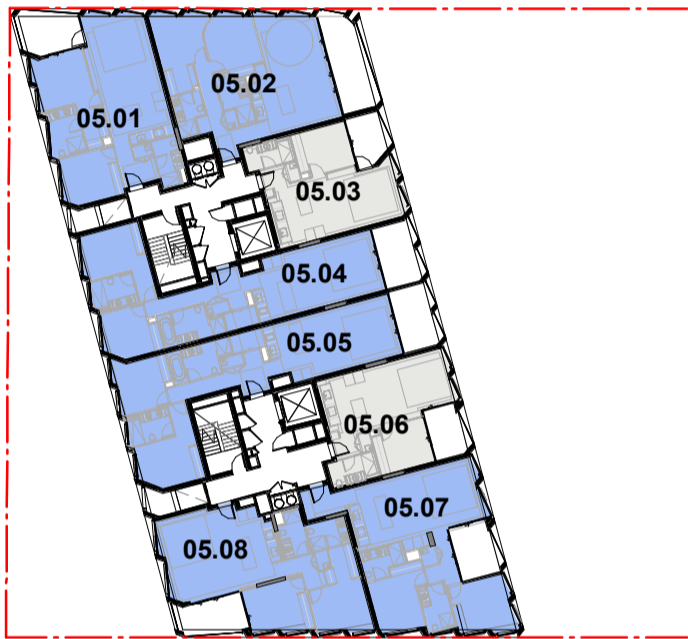

CROSS VENT_LEVEL 05



CROSS VENT_LEVEL 06



CROSS VENT_LEVEL 07

CROSS VENT. SUMMARY

79% (41/52) OF RESIDENTIAL UNITS ARE NATURALLY CROSS VENTILATED IN THE FIRST NINE STOREYS OF THE BUILDING

LEGEND

- CROSS VENTILATION ACHIEVED ON THE FIRST SEVEN STOREYS
- CROSS VENTILATION NOT ACHIEVED IN THE FIRST SEVEN STOREYS

ADG DESIGN CRITERIA

AT LEAST 60% OF APARTMENTS ARE NATURALLY VENTILATED IN THE FIRST SEVEN STOREYS OF THE BUILDING.

Precinct + Building 3W + 4S

SJB Architects
Level 2, 490 Crown St
Surry Hills NSW
2010 Australia
T 61 2 9380 9911
sjb.com.au



Building 3N & 3S

Durbach Block Jaggers
Level 2, 9 Roslyn St
Potts Point NSW
2011 Australia
T 61 2 8297 3500
durbachblockjaggers.com

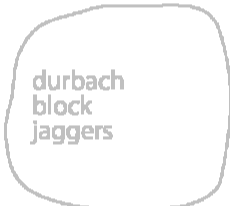

Building 4N

Curious Practice
24/526 Hunter Street,
Newcastle NSW
2300 Australia
T 61 4 1182 4600
curiouspractice.com

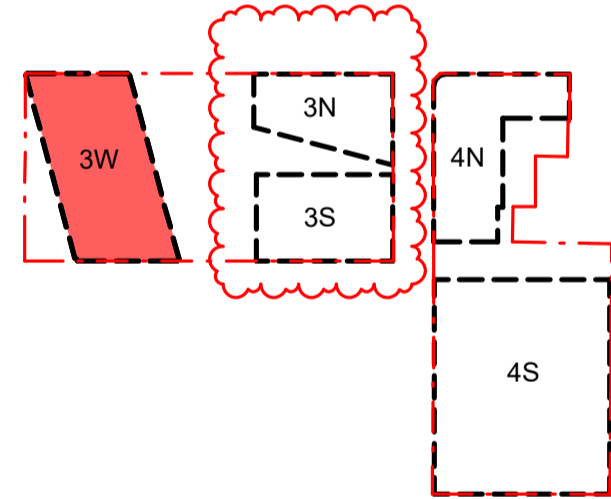

Client



Project

EAST END STAGE 3&4

Hunter, Morgan, Newcomen, King
Streets NEWCASTLE NSW 2300

Country: AWABAKAL

Drawing Name

COMPLIANCE DIAGRAMS
DIAGRAMS - 3W - CROSS
VENTILATION

Drawn

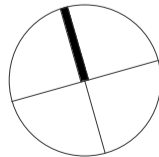
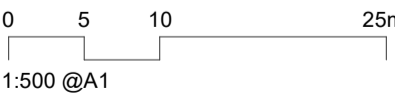

Date Scale Sheet Size

15.10.2024 As indicated @ A1

Drawn. Chk. Revision

JG RY 4

Job No. Drawing No.

6668 DA-3W-8002

In accepting and utilising this document the recipient agrees that SJB Architecture (NSW) Pty. Ltd. ACN 081 094 724 T/A SJB Architects, retain all common law, statutory law and other rights including copyright and intellectual property rights. The recipient agrees not to use this document for any purpose other than its intended use; to waive all claims against SJB Architects resulting from unauthorised changes; or to reuse the document on other projects without prior written consent from SJB Architects. Under no circumstances shall transfer of this document be deemed a sale. SJB Architects makes no warranties of fitness for any purpose. The Builder/Contractor shall verify job dimensions prior to any work commencing. Use figured dimensions only. Do not scale drawings.

FOR APPROVAL

Rev	Date	Revision	By	Chk.
1	08.03.2023	FOR INFORMATION	JG	RY
2	31.03.2023	ISSUE FOR DA	JG	RY
3	20.12.2023	ISSUE FOR COUNCIL	GS	RY
4	15.10.2024	COUNCIL RFI	JG	WG

Precinct + Building 3W + 4S

SJB Architects
Level 2, 490 Crown St
Surry Hills NSW
2010 Australia
T 61 2 9380 9911
sjb.com.au



Building 3N & 3S

Durbach Block Jaggers
Level 2, 9 Roslyn St
Potts Point NSW
2011 Australia
T 61 2 8297 3500
durbachblockjaggers.com

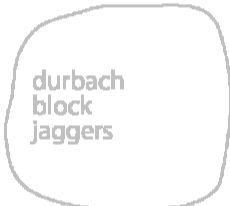

Building 4N

Curious Practice
24/526 Hunter Street,
Newcastle NSW
2300 Australia
T 61 4 1182 4600
curiouspractice.com

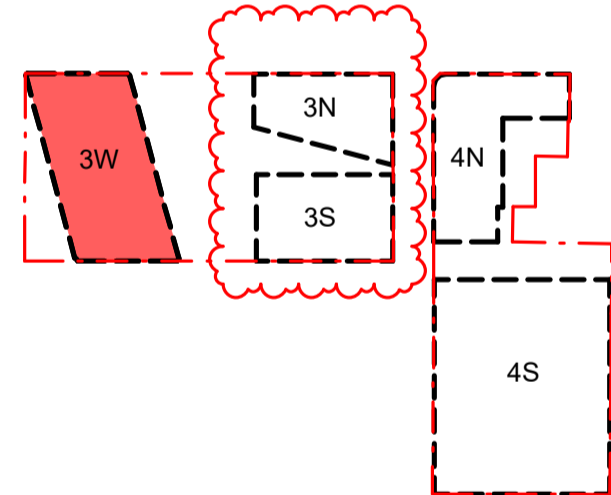

Client

iris

Project

EAST END STAGE 3&4

Hunter, Morgan, Newcomen, King
Streets NEWCASTLE NSW 2300

Country: AWABAKAL

Drawing Name

AREA PLANS - 3W - GFA

Drawn

0 5 10 25m
1:500 @A1

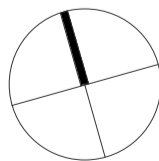

Date Scale Sheet Size

15.10.2024 As indicated @ A1

Drawn Chk. Revision

JG RY 4

Job No. Drawing No.

6668 DA-3W-8101

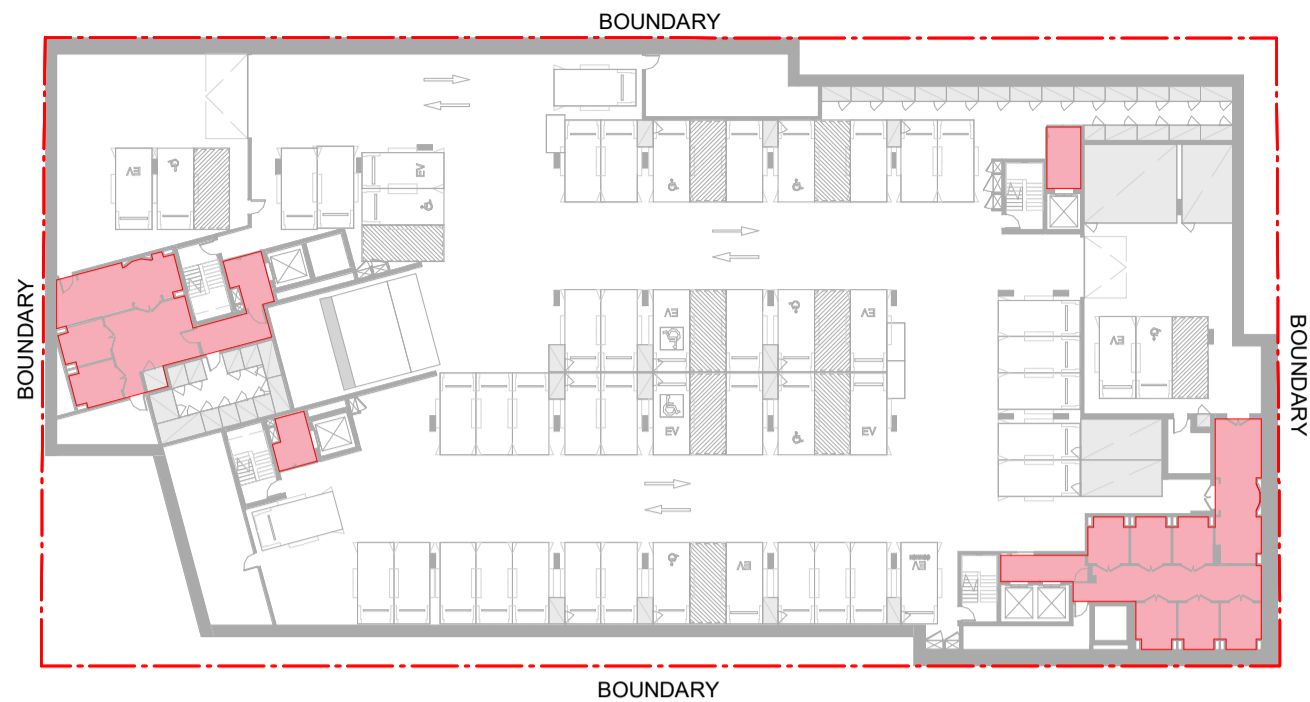

BASEMENT 3

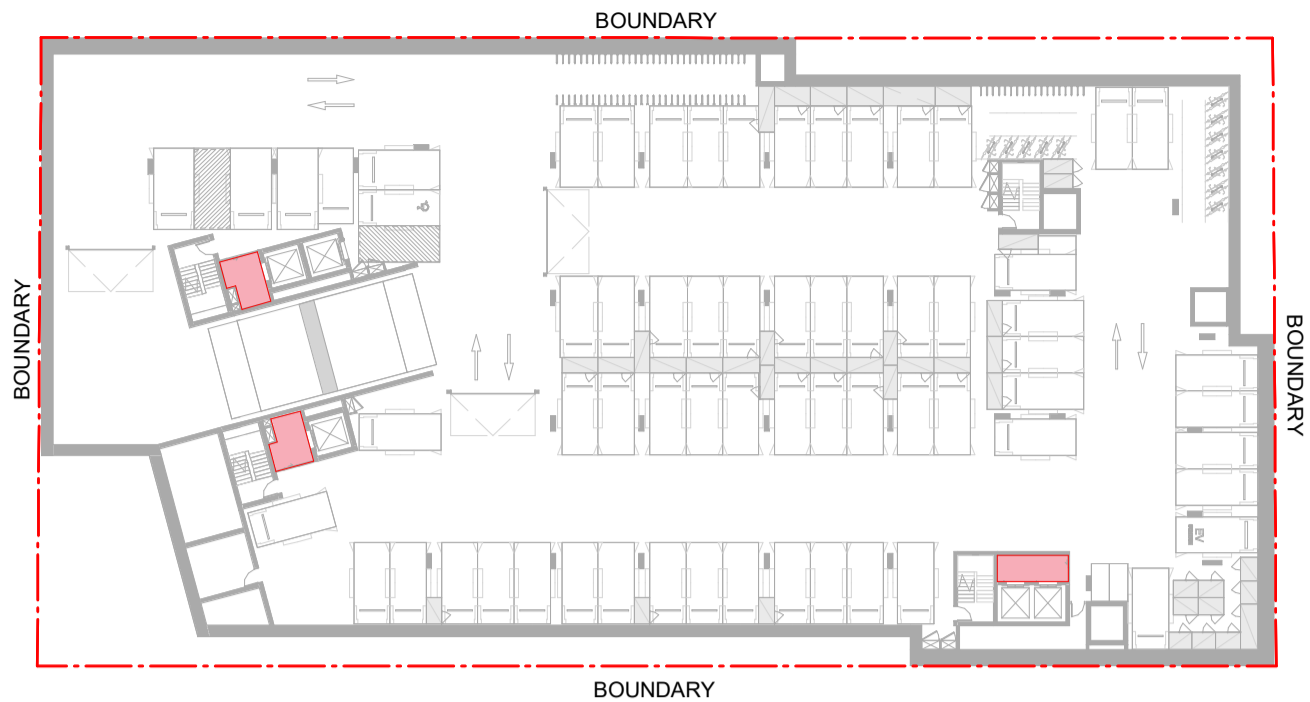

BASEMENT 2

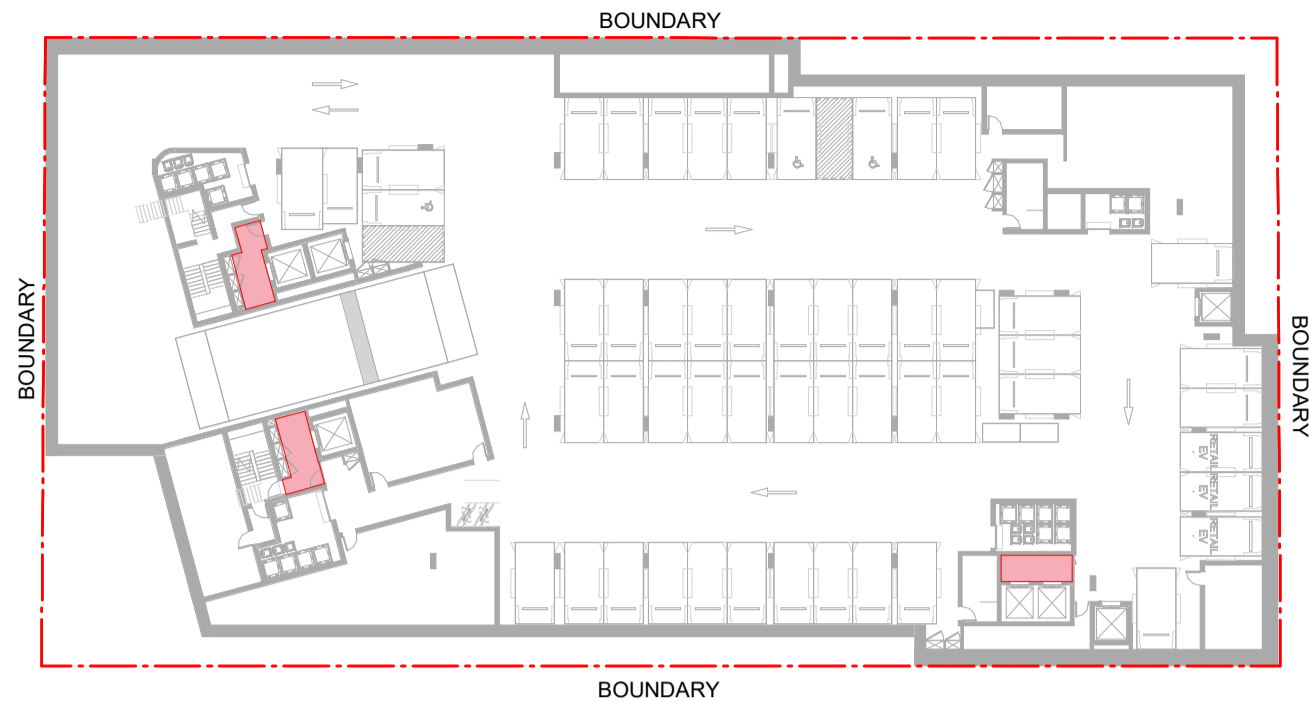

BASEMENT 1

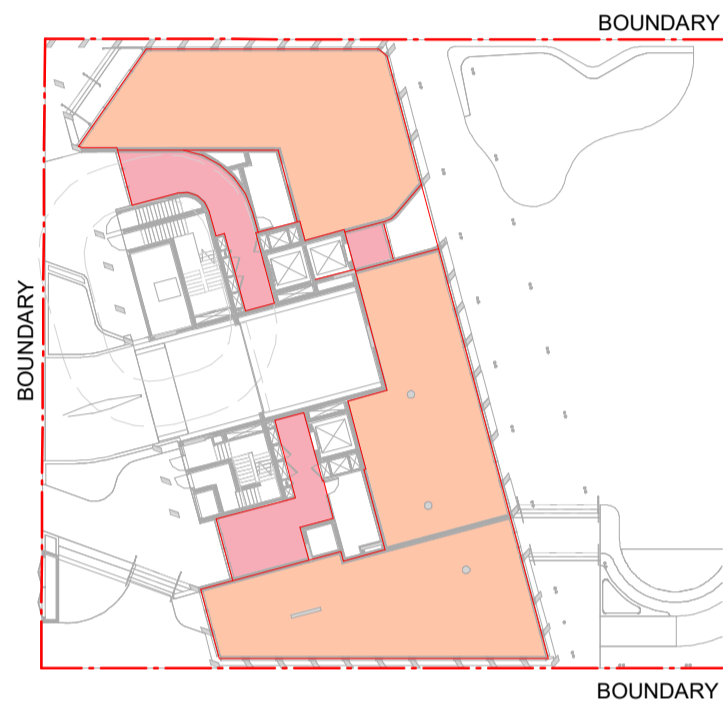

GROUND FLOOR

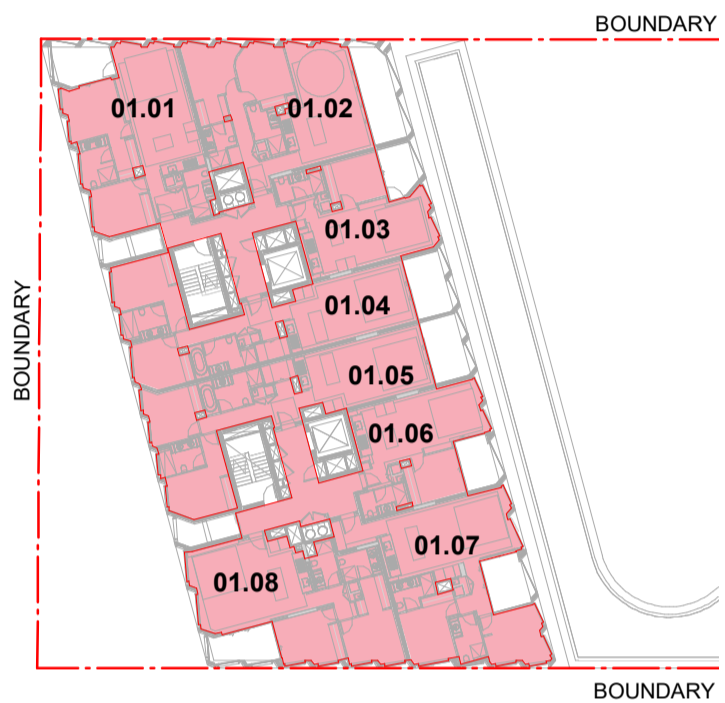

LEVEL 01

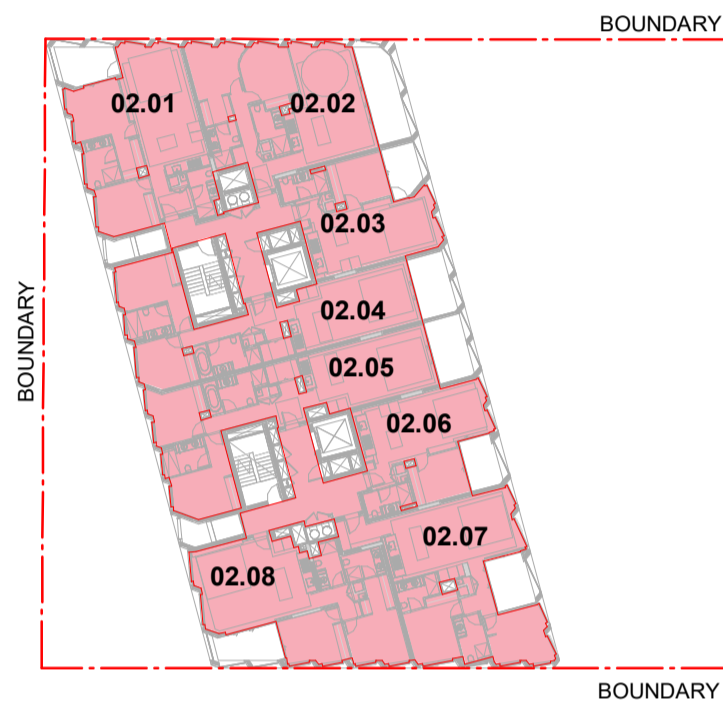

LEVEL 02

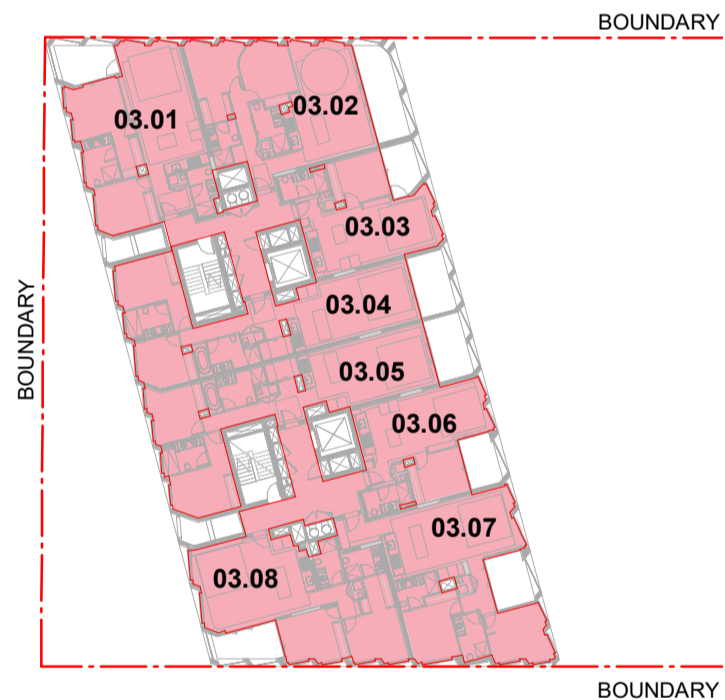

LEVEL 03

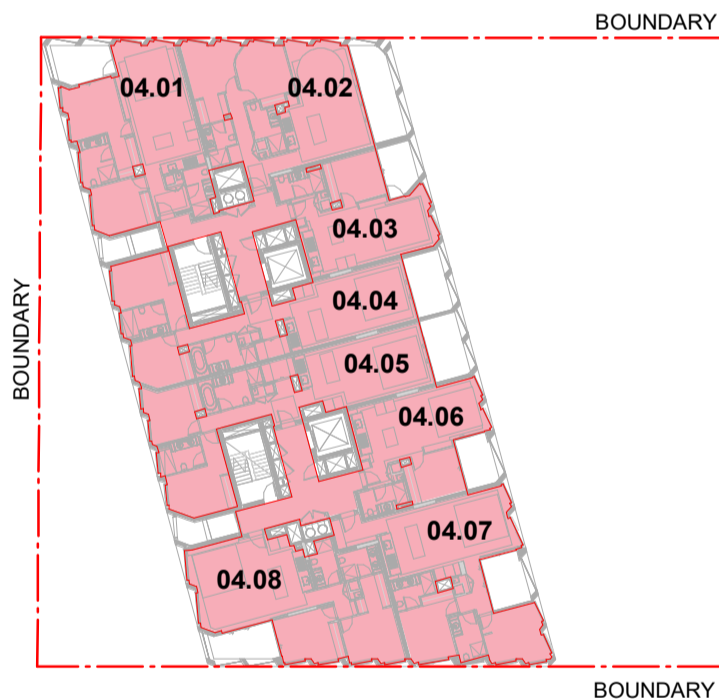

LEVEL 04

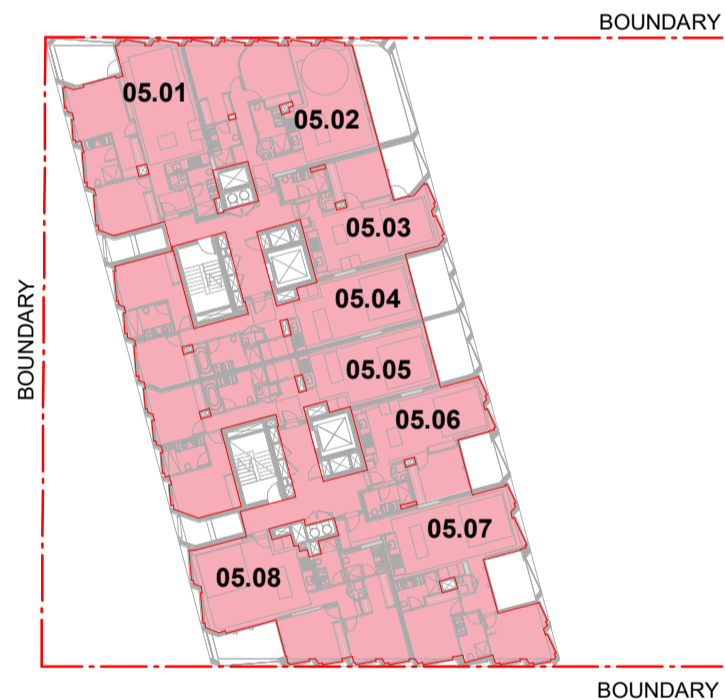

LEVEL 05

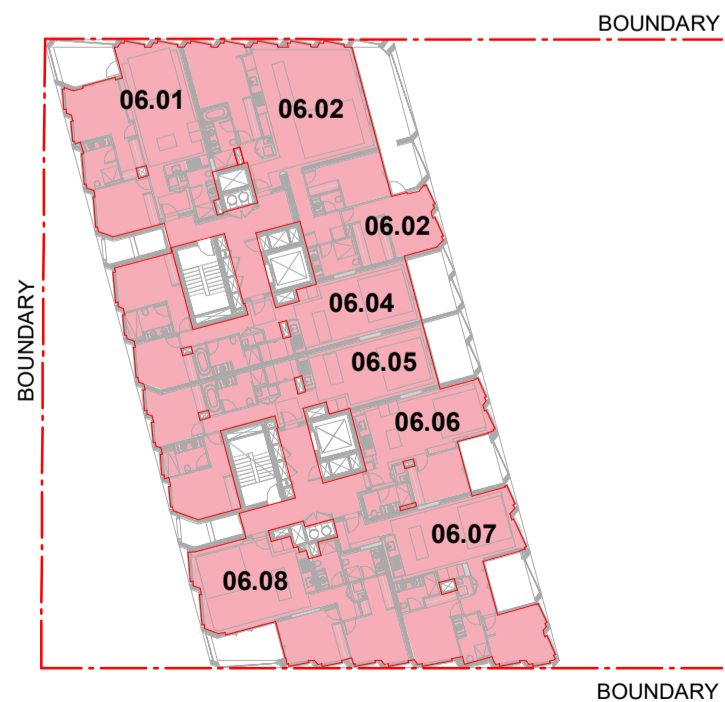

LEVEL 06

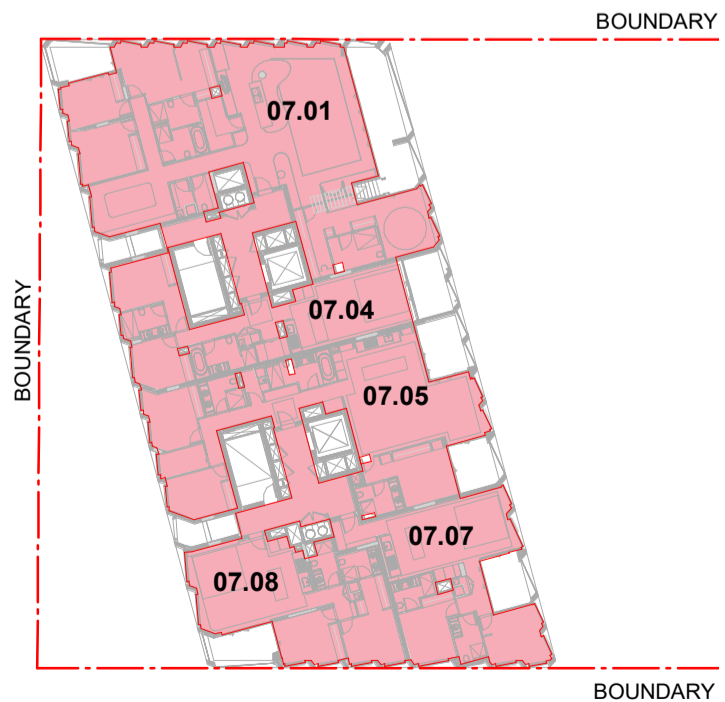

LEVEL 07

Area Schedule (GFA)	
Level	Area
BASEMENT 3	222 m ²
BASEMENT 2	24 m ²
BASEMENT 1	29 m ²
GROUND FLOOR	535 m ²
LEVEL 01	723 m ²
LEVEL 02	723 m ²
LEVEL 03	723 m ²
LEVEL 04	723 m ²
LEVEL 05	723 m ²
LEVEL 06	724 m ²
LEVEL 07	717 m ²
Grand total	5867 m ²

In accepting and utilising this document the recipient agrees that SJB Architecture (NSW) Pty Ltd, ACN 081 094 724 T/A SJB Architects, retain all common law, statutory law and other rights including copyright and intellectual property rights. The recipient agrees not to use this document for any purpose other than its intended use; to waive all claims against SJB Architects resulting from unauthorised changes; or to reuse the document on other projects without prior written consent from SJB Architects. Under no circumstances shall transfer of this document be deemed a sale. SJB Architects makes no warranties of fitness for any purpose. The Builder/Contractor shall verify job dimensions prior to any work commencing. Use figured dimensions only. Do not scale drawings.

FOR APPROVAL

Rev	Date	Revision	By	Chk.
1	08.03.2023	FOR INFORMATION	JG	RY
2	08.03.2023	FOR INFORMATION	JG	RY
3	31.03.2023	ISSUE FOR DA	JG	RY
4	15.10.2024	COUNCIL RFI	JG	WG

Precinct + Building 3W + 4S

SJB Architects
Level 2, 490 Crown St
Surry Hills NSW
2010 Australia
T 61 2 9380 9911
sjb.com.au



Building 3N & 3S

Durbach Block Jaggers
Level 2, 9 Roslyn St
Potts Point NSW
2011 Australia
T 61 2 8297 3500
durbachblockjaggers.com

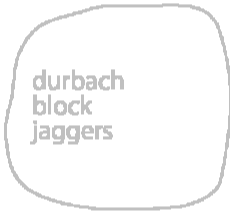

Building 4N

Curious Practice
24/526 Hunter Street,
Newcastle NSW
2300 Australia
T 61 4 1182 4600
curiouspractice.com



Client



Project

EAST END STAGE 3&4

Hunter, Morgan, Newcomen, King
Streets NEWCASTLE NSW 2300

Country: AWABAKAL

Drawing Name

MATERIAL SCHEDULE - 3W

Drawn

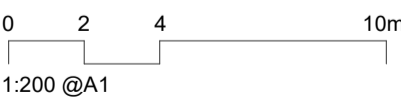

Date	Scale	Sheet Size
15.10.2024	As indicated	@ A1

Drawn	Chk.	Revision
JG	RY	4

Job No.	Drawing No.
---------	-------------

6668	DA-3W-9001
------	------------

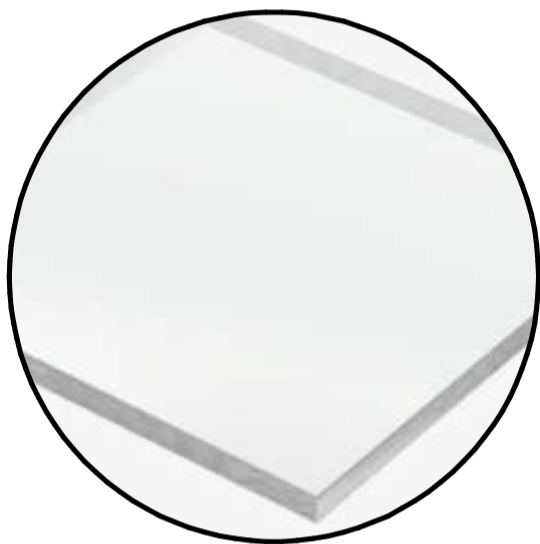
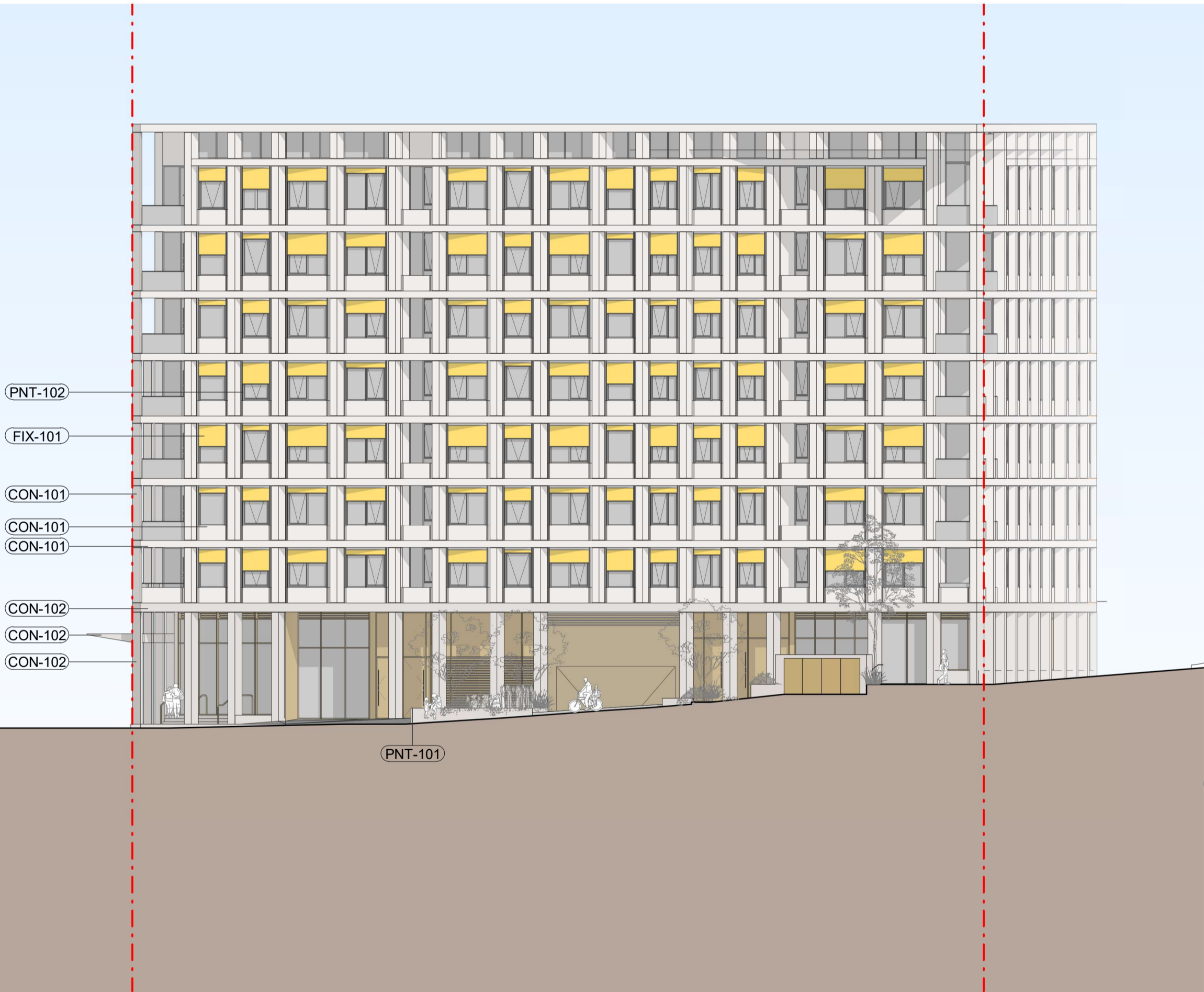

BAL-101
Glass Balustrade

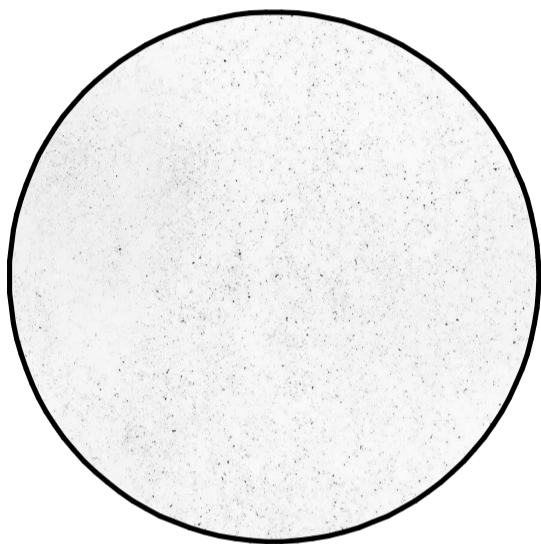

CON-101
Light Concrete

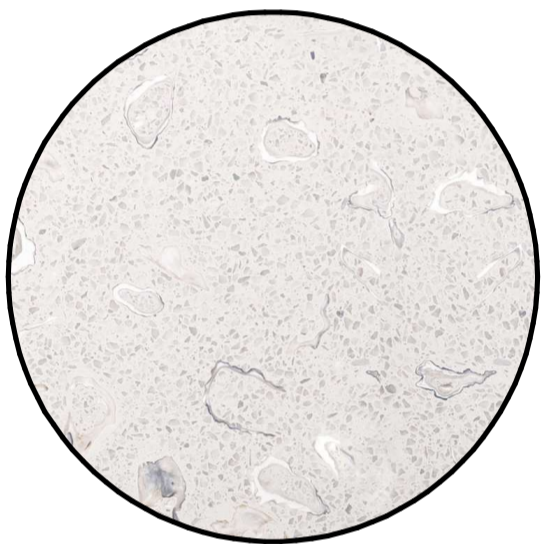

CON-102
Aggregate Concrete

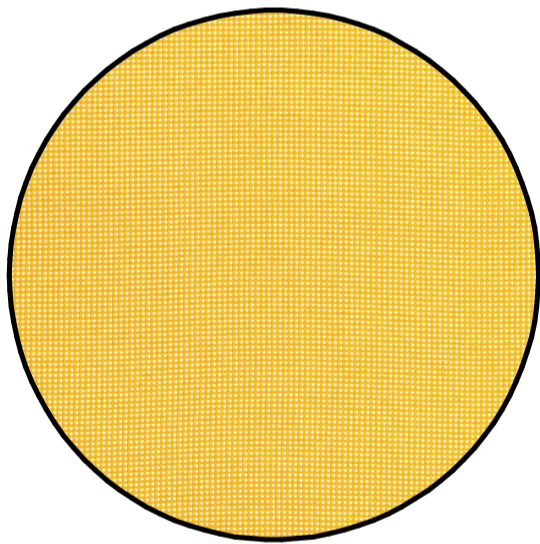

FIX-101
Yellow External Blind

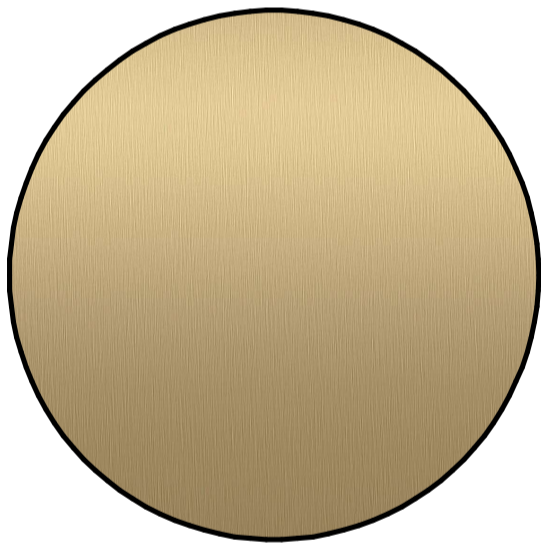

PNT-101
Brass Coloured Metalwork

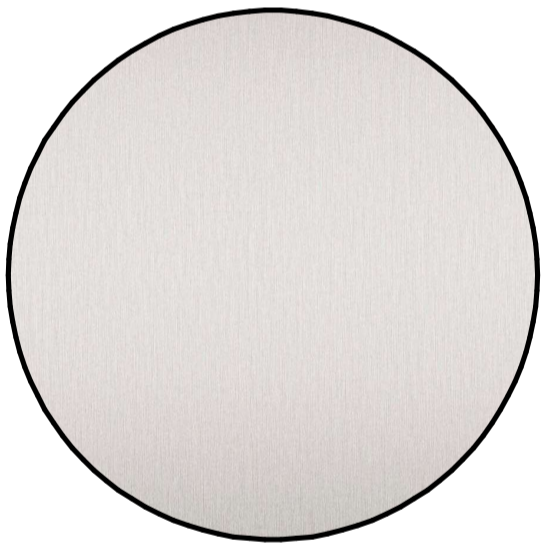

PNT-102
Anodised Metalwork